



Site Location Maps

Building Communities...Creating Opportunities...Transforming Lives

Updated 02/2020

Public Housing Communities

- **N.J. 9-2, Marion Gardens**
- **N.J. 9-3, Booker T. Washington Apartments**
- **N.J. 9-4, Hudson Gardens**
- **N.J. 9-5, Holland Gardens**
- **N.J. 9-8, Curries Woods**
- **N.J. 9-9, Berry Gardens**
- **N.J. 9-10, Dwight Street Homes**
- **N.J. 9-16, Thomas J. Stewart Apartments**

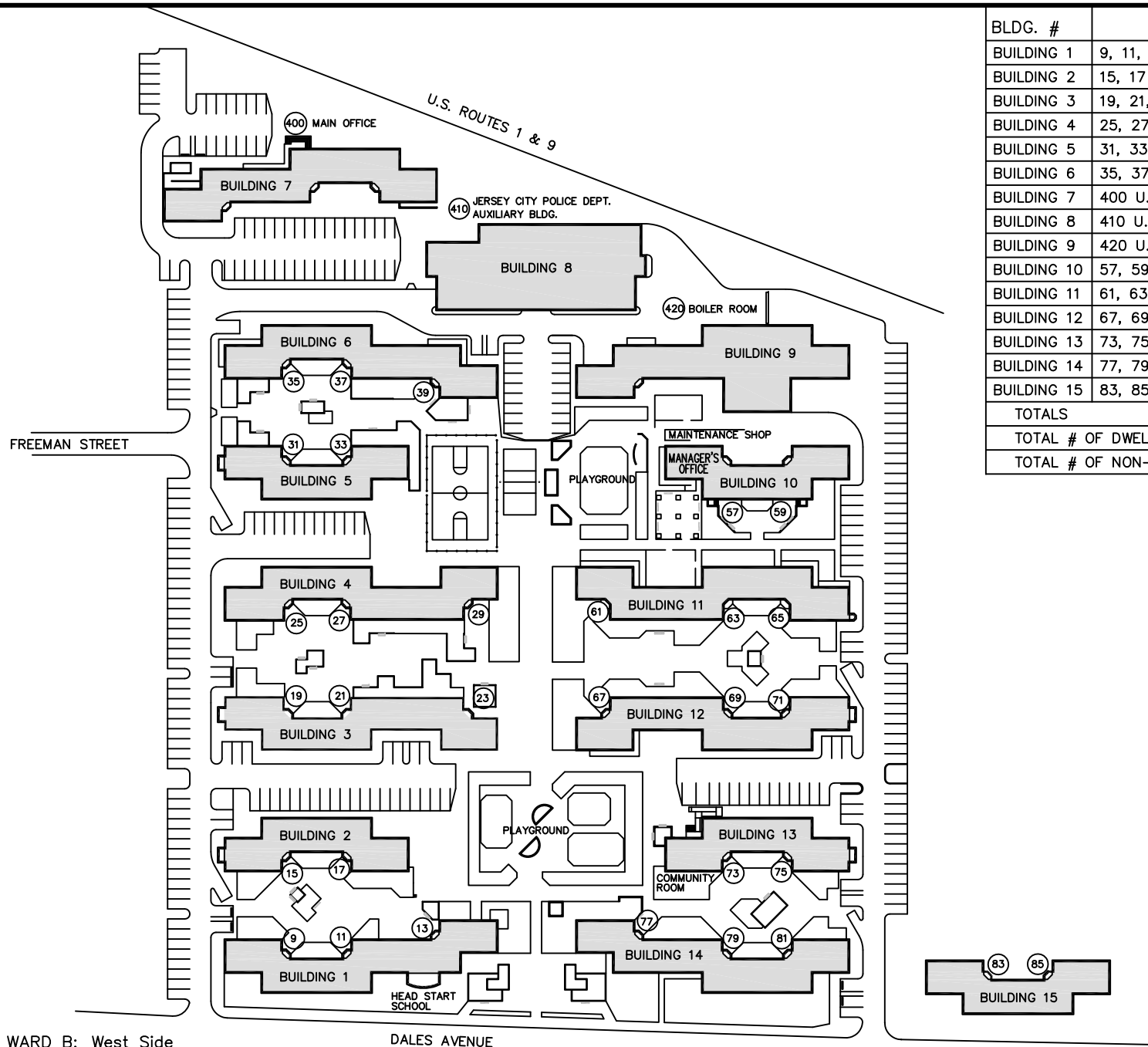

BLDG. #	ADDRESSES	BLDG. AREA*	# OF UNITS
BUILDING 1	9, 11, 13 DALES AVENUE	8,609 SF	20
BUILDING 2	15, 17 DALES AVENUE	5,756 SF	14
BUILDING 3	19, 21, 23 DALES AVENUE	8,609 SF	23
BUILDING 4	25, 27, 29 DALES AVENUE	8,609 SF	23
BUILDING 5	31, 33 DALES AVENUE	5,756 SF	15
BUILDING 6	35, 37, 39 DALES AVENUE	8,609 SF	24
BUILDING 7	400 U.S. HIGHWAY 1	8,609 SF	0
BUILDING 8	410 U.S. HIGHWAY 1	14,041 SF	0
BUILDING 9	420 U.S. HIGHWAY 1	11,542 SF	0
BUILDING 10	57, 59 DALES AVENUE	5,756 SF	13
BUILDING 11	61, 63, 65 DALES AVENUE	8,609 SF	23
BUILDING 12	67, 69, 71 DALES AVENUE	8,609 SF	23
BUILDING 13	73, 75 DALES AVENUE	5,756 SF	16
BUILDING 14	77, 79, 81 DALES AVENUE	8,609 SF	24
BUILDING 15	83, 85 DALES AVENUE	5,756 SF	15
TOTALS		123,235 SF	233
TOTAL # OF DWELLING UNITS			228
TOTAL # OF NON-DWELLING UNITS			5

*GROSS FIRST FLOOR AREA

SITE AREA: 12.33 AC
OLD TAX BLOCK: 1627.1 LOT: A

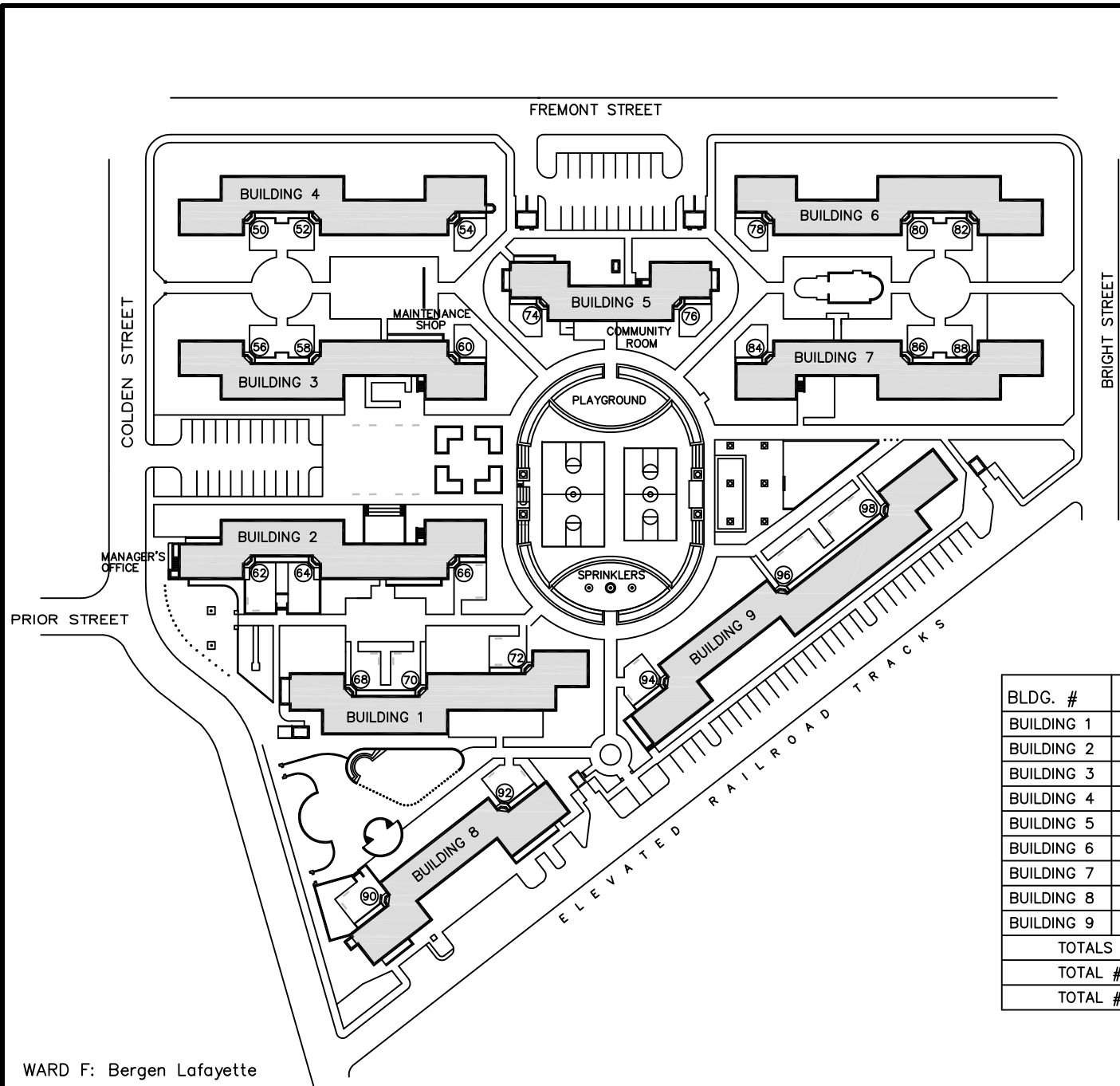

BOILER ROOMS	
BUILDING #	LOCATION
BUILDING 1	68 FREMONT STREET, APT. 102
BUILDING 2	62 FREMONT STREET, APT. 201
BUILDING 3	56 FREMONT STREET, APT. 304
BUILDING 4	54 FREMONT STREET, APT. 425
BUILDING 5	76 FREMONT STREET, APT. 513
BUILDING 6	80 FREMONT STREET, APT. 613
BUILDING 7	86 FREMONT STREET, APT. 713
BUILDING 8	90 FREMONT STREET, APT. 801
BUILDING 9	94 FREMONT STREET, APT. 901

BLDG. #	ADDRESSES	BLDG. AREA*	# OF UNITS
BUILDING 1	68, 70, 72 FREMONT STREET	8,525 SF	36
BUILDING 2	62, 64, 66 FREMONT STREET	8,643 SF	36
BUILDING 3	56, 58, 60 FREMONT STREET	8,643 SF	36
BUILDING 4	50, 52, 54 FREMONT STREET	8,643 SF	35
BUILDING 5	74, 76 FREMONT STREET	5,779 SF	24
BUILDING 6	78, 80, 82 FREMONT STREET	8,584 SF	36
BUILDING 7	84, 86, 88 FREMONT STREET	8,584 SF	36
BUILDING 8	90, 92 FREMONT STREET	7,069 SF	32
BUILDING 9	94, 96, 98 FREMONT STREET	11,200 SF	48
TOTALS		75,670 SF	319
TOTAL # OF DWELLING UNITS			307
TOTAL # OF NON-DWELLING UNITS			12

*GROSS FIRST FLOOR AREA

WARD F: Bergen Lafayette
ZONE: Montgomery Street

SITE AREA: 7.68 AC
OLD TAX BLOCK: 2114 LOT: K1



PROJECT N.J. 9-3
BOOKER T. WASHINGTON APTS.
JERSEY CITY, NJ 07302

SITE PLAN
BLOCK: 13604 LOT: 1
REVISED: 02/2020

SCALE:

X:\JCHA Site Maps\Updated 2020\NJ9-03, Booker T. Washington Apts.dwg

BLDG. #	ADDRESSES	BLDG. AREA*	# OF UNITS
BUILDING 1	9, 11 PALISADE AVENUE	5,779 SF	32
BUILDING 2	13, 15, 17 PALISADE AVENUE	8,584 SF	40
BUILDING 3	19, 21, 23 PALISADE AVENUE	8,584 SF	40
BUILDING 4	27, 29, 33, 35 PALISADE AVENUE	11,082 SF	64
BUILDING 5	37, 39 PALISADE AVENUE	5,354 SF	24
BUILDING 6	41, 43 PALISADE AVENUE	5,354 SF	24
TOTALS		44,737 SF	224
TOTAL # OF DWELLING UNITS			221
TOTAL # OF NON-DWELLING UNITS			3

*GROSS FIRST FLOOR AREA

BOILER ROOMS	
BUILDING #	LOCATION
BUILDING 2	BASEMENT
BUILDING 3	BASEMENT
BUILDING 4	BASEMENT
BUILDING 5	BASEMENT
BUILDING 6	BASEMENT

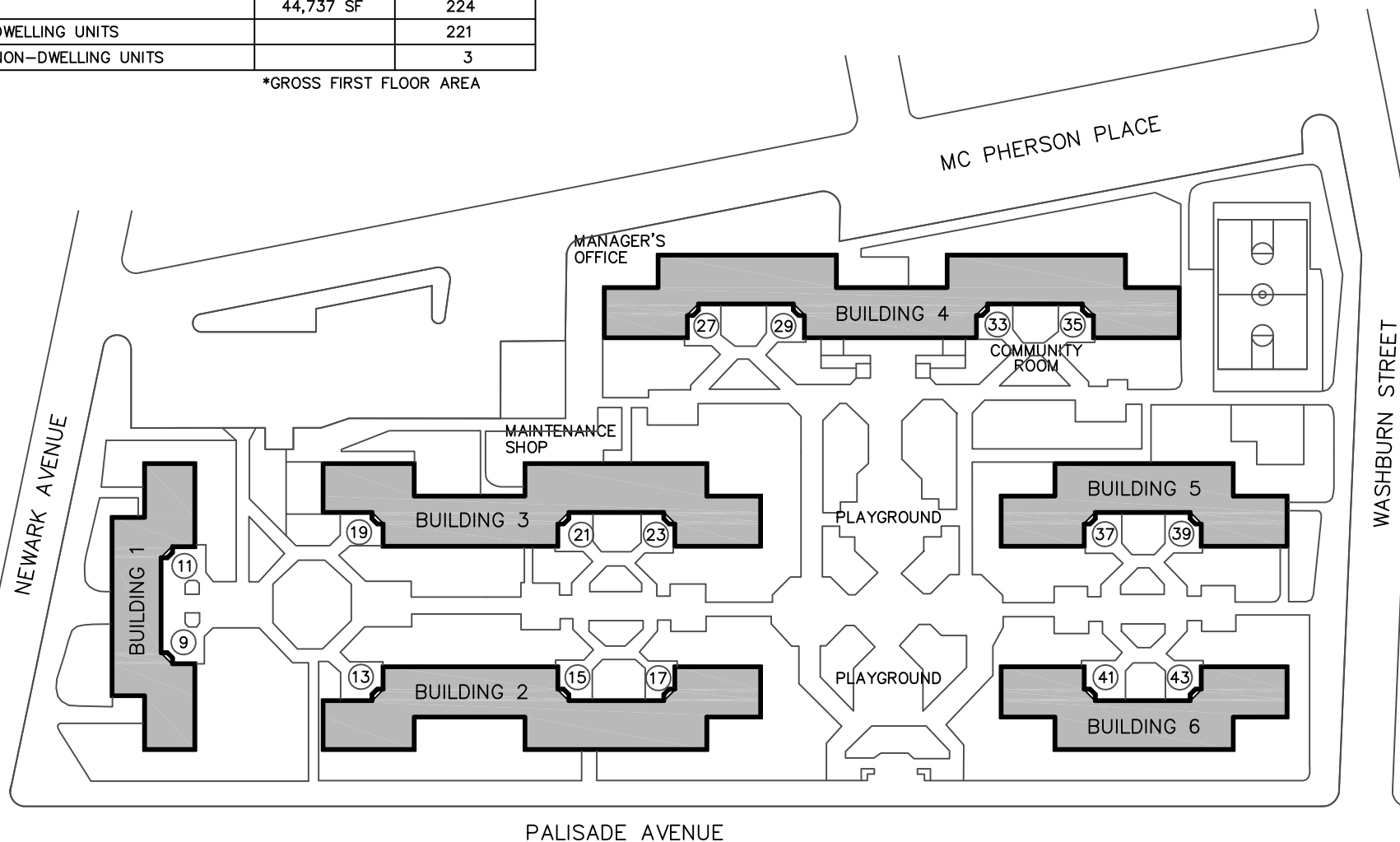

WARD C: Journal Square
ZONE: R-3 Multi-Family Mid-Rise

SITE AREA: 4.46 AC
OLD TAX BLOCK: 532.1 LOT: A2

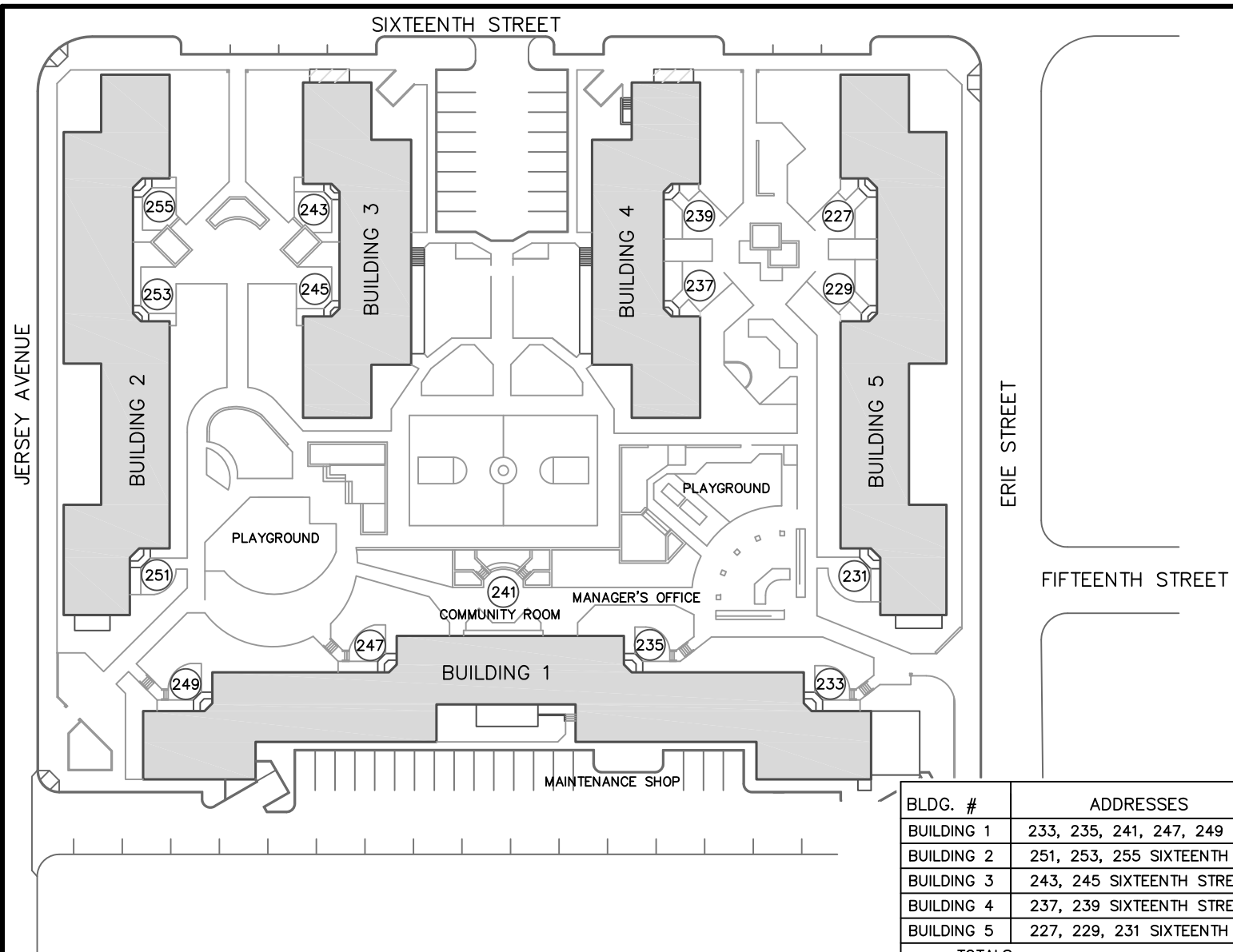

BOILER ROOMS	
BUILDING #	LOCATION
BUILDING 1	BASEMENT
BUILDING 3	BASEMENT
BUILDING 4	BASEMENT

BLDG. #	ADDRESSES	BLDG. AREA*	# OF UNITS
BUILDING 1	233, 235, 241, 247, 249 SIXTEENTH STREET	11,507 SF	56
BUILDING 2	251, 253, 255 SIXTEENTH STREET	8,584 SF	36
BUILDING 3	243, 245 SIXTEENTH STREET	5,354 SF	32
BUILDING 4	237, 239 SIXTEENTH STREET	5,354 SF	32
BUILDING 5	227, 229, 231 SIXTEENTH STREET	8,584 SF	36
TOTALS		39,383 SF	192
TOTAL # OF DWELLING UNITS			189
TOTAL # OF NON-DWELLING UNITS			3

*GROSS FIRST FLOOR AREA

WARD E: Downtown
ZONE: Jersey Avenue Light Rail

SITE AREA: 3.31 AC
OLD TAX BLOCK: 290 LOT: 1A



PROJECT N.J. 9-5
HOLLAND GARDENS
JERSEY CITY, NJ 07310

SITE PLAN
BLOCK: 7101 LOT: 1
REVISED: 02/2020

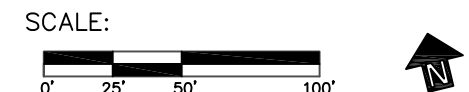

PHASE I TOWNHOUSES – 46 UNITS	BLDG. AREA*	PHASE IV TOWNHOUSES – 40 UNITS	BLDG. AREA*
2, 4, 6, 8, 10, 12, 14, 16 HOPE LANE	28,686 SF	40, 42, 44, 46, 48, 50, 52 NEW HECKMAN DRIVE	25,225 SF
24, 26, 27, 28, 29, 30, 31, 32, 33, 34, 35, 37, 39 PEACE DRIVE		54, 56, 58, 60, 62, 64, 66, 68, 70, 72, 74, 76, 78, 80, 82, 84, 86, 88, 90, 92, 94, 96, 98, 100 NEW HECKMAN DRIVE	
32, 34, 36, 38, 40, 42, 44, 46 RUBY BROWN TERRACE		48, 50, 52, 54, 56, 58, 60, 62, 64 RUBY BROWN TERRACE	
13, 15, 17, 19, 21, 23, 25, 27, 29, 31, 33, 35, 37 NEW HECKMAN DRIVE		PHASE V TOWNHOUSES – 80 UNITS	BLDG. AREA*
19, 21, 23, 25 GARDEN TERRACE		126, 128, 130, 132, 134, 136, 138 MERRITT STREET	50,340 SF
PHASE II TOWNHOUSES – 20 UNITS	BLDG. AREA*	10, 12, 14, 16, 18, 20, 22, 24, 26, 28, 30 RUBY BROWN TERRACE	
1, 3, 5, 7 OLD BERGEN ROAD	12,328 SF	6, 7, 8, 9, 10, 11, 12, 13, 14, 15, 16, 17, 18, 19, 20, 21, 22, 23, 25 PEACE DRIVE	
2, 4, 6, 8, 10, 12, 14, 16, 18, 20, 22, 24, 26, 28, 30, 32 NEW HECKMAN DRIVE		4, 5, 6, 7, 8, 9, 10, 11, 12, 13, 14, 15, 16, 17, 18, 20, 22, 24, 26, 28, 30, 32, 34, 36, 38 GARDEN TERRACE	
PHASE III TOWNHOUSES – 18 UNITS	BLDG. AREA*	3, 4, 5, 6, 7, 8, 9, 10, 11, 12, 13, 14, 15, 16, 17, 18, 19, 21 LIGGIONS LANE	
1–1, 1–2, 1A–1, 1A–2 NEW HECKMAN DRIVE	13,524 SF	PHASE I TOWER – 91 UNITS	BLDG. AREA*
112–1, 112–2, 114–1, 114–2, 116–1, 116–2 MERRITT STREET		3 NEW HECKMAN DRIVE	6,927 SF
118–1, 118–2, 120–1, 120–2, 122–1, 122–2, 124–1, 124–2 MERRITT STREET		COMMUNITY REVITALIZATION CENTER	BLDG. AREA*
		65–67 RUBY BROWN TERRACE	14,500 SF
		TOTAL BLDG. AREA*	151,530 SF
		TOTAL # OF DWELLING UNITS	295

*GROSS FIRST FLOOR AREA

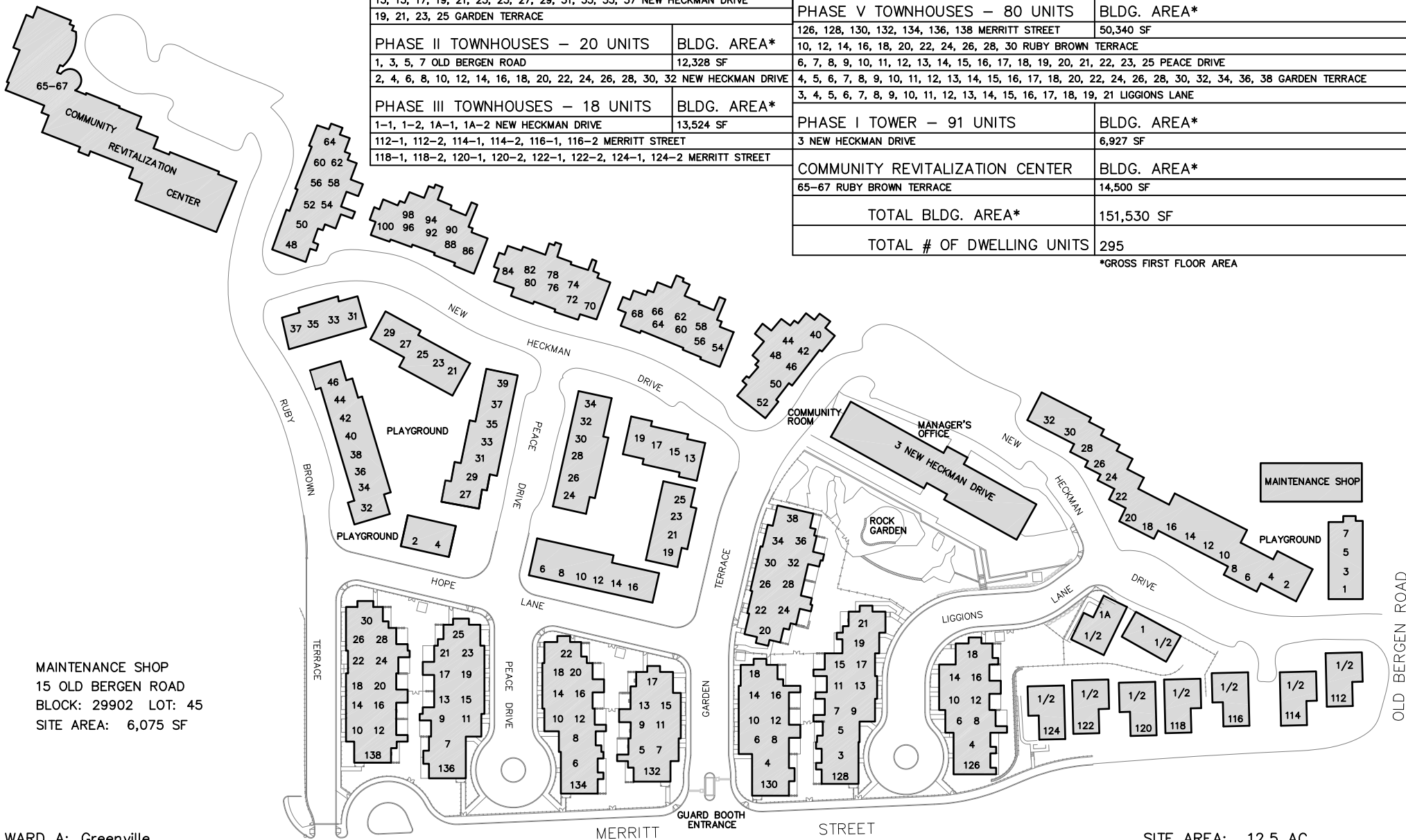

MAINTENANCE SHOP
15 OLD BERGEN ROAD
BLOCK: 29902 LOT: 45
SITE AREA: 6,075 SF

WARD A: Greenville
ZONE: R-3 Multi-Family Mid-Rise

SITE AREA: 12.5 AC
OLD TAX BLOCK: 1381 LOT: W8



65-67 RUBY BROWN TERRACE	
HEAD START SCHOOL	5,578 SF
SUPPORTIVE SERVICES	5,058 SF
COMMUNITY ROOM	3,864 SF
TOTAL BLDG. AREA*	14,500 SF

*GROSS FIRST FLOOR AREA

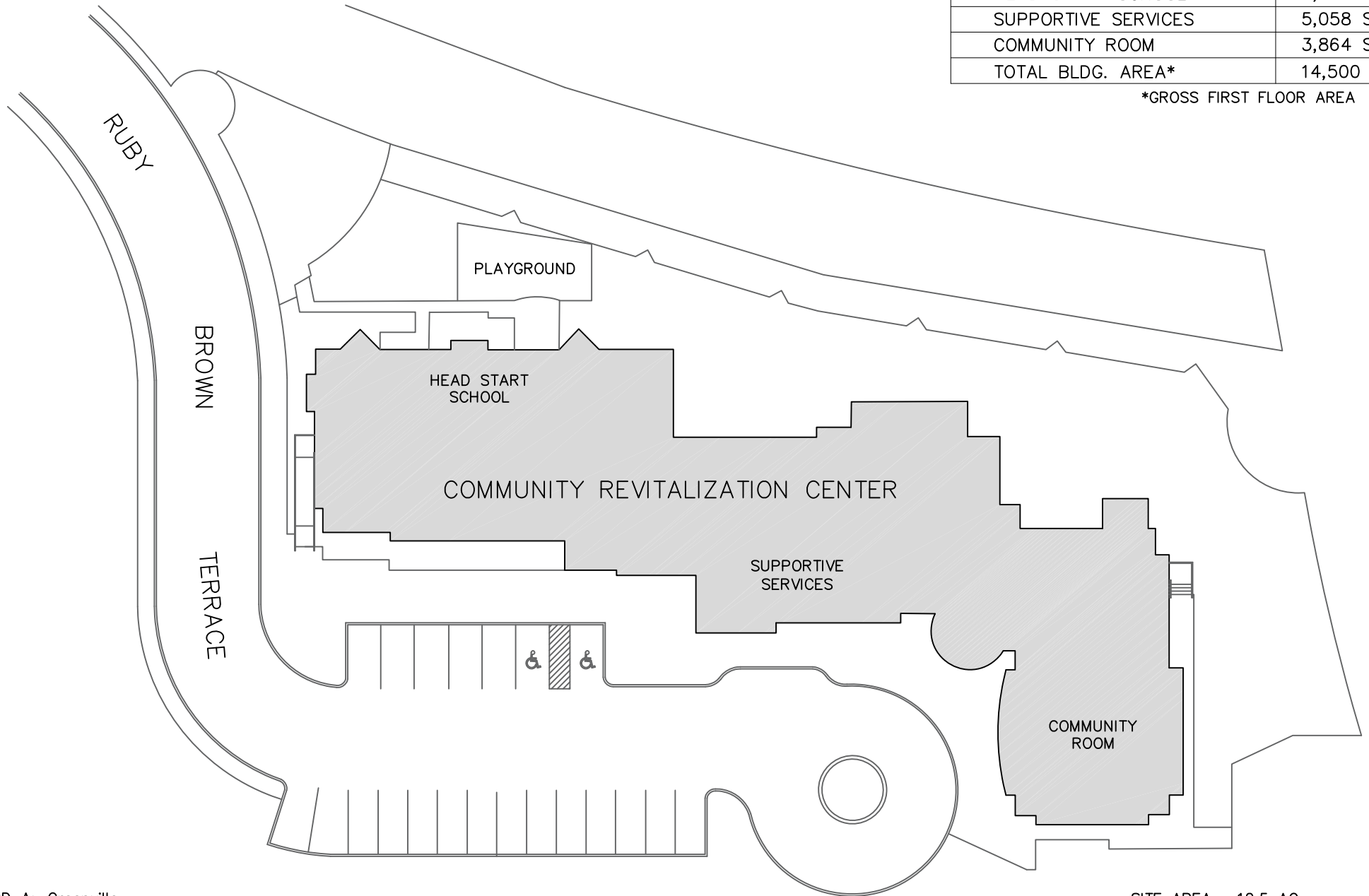

WARD A: Greenville
 ZONE: R-3 Multi-Family Mid-Rise

SITE AREA: 12.5 AC
 OLD TAX BLOCK: 1381 LOT: W8



BLDG. #	ADDRESSES	# OF UNITS
BUILDING A	199 OCEAN AVENUE	156
BUILDING B	92 DANFORTH AVENUE	130
BUILDING C	82 DANFORTH AVENUE	40
BUILDING D	72 DANFORTH AVENUE	42
TOTAL # OF UNITS		368
TOTAL # OF DWELLING UNITS		356
TOTAL # OF NON-DWELLING UNITS		12

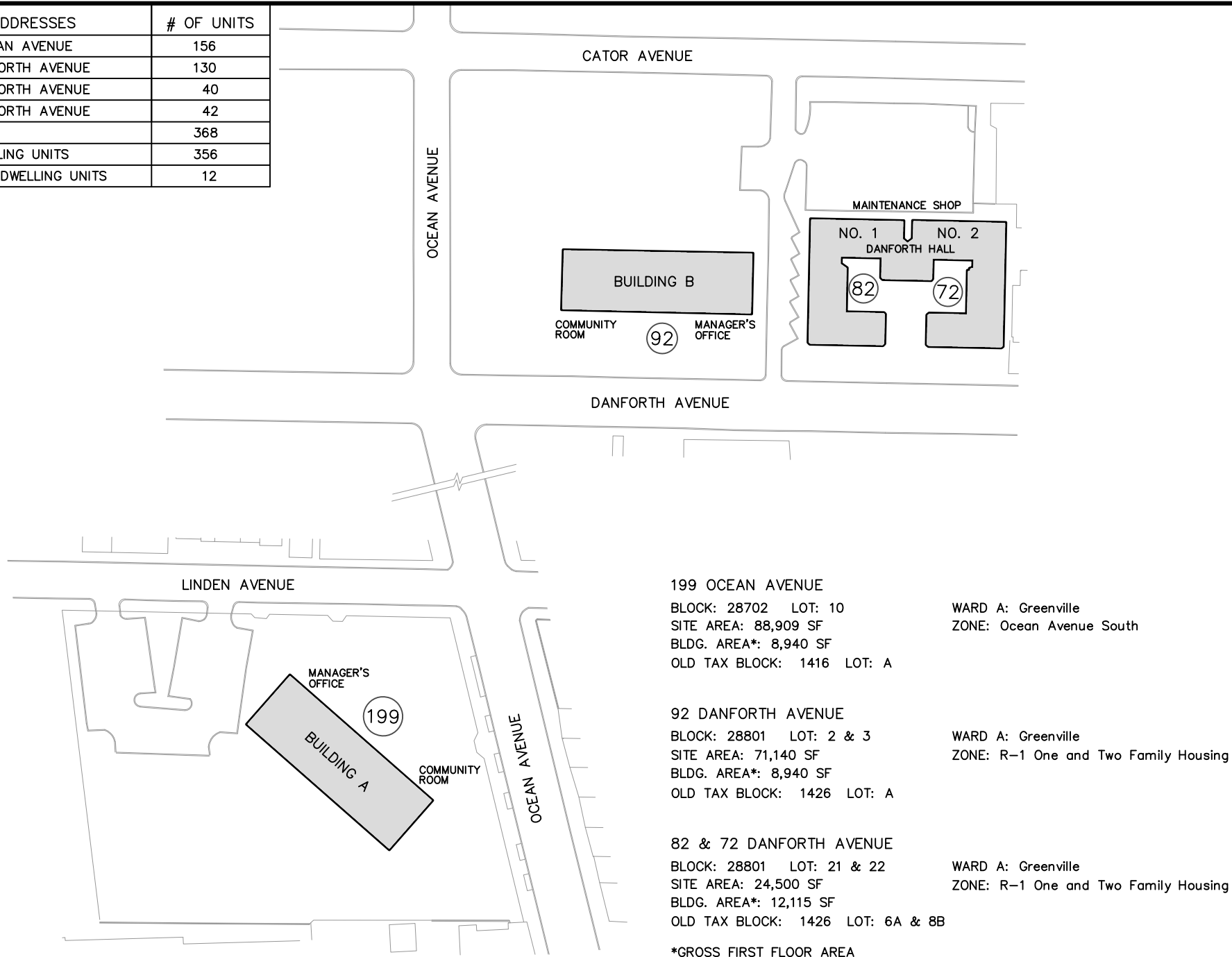

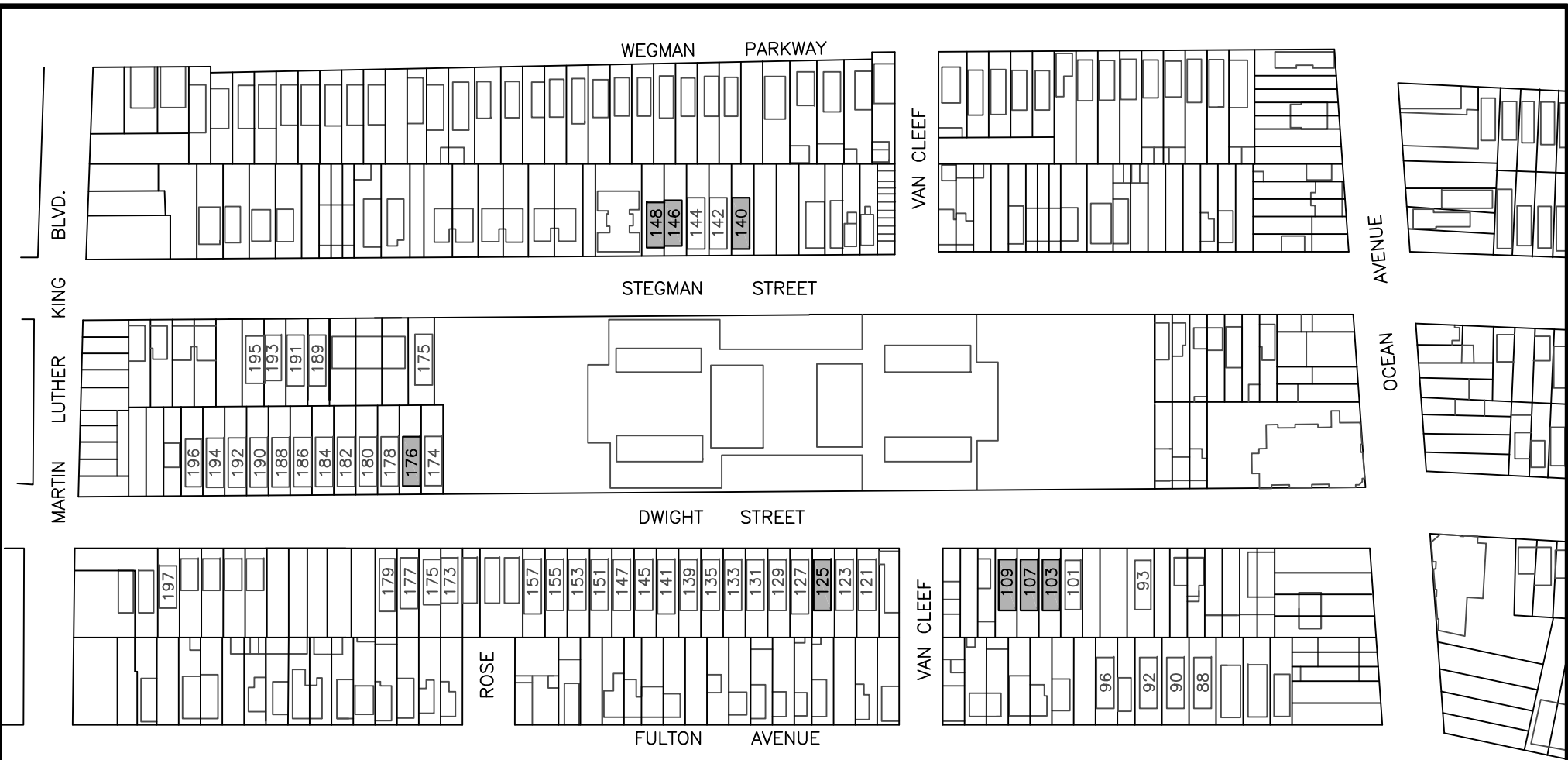

WARD F: Bergen Lafayette
 ZONE: Turnkey

ADDRESSES	OLD BLOCK	OLD LOT	NEW BLOCK	NEW LOT	ADDRESSES	OLD BLOCK	OLD LOT	NEW BLOCK	NEW LOT	ADDRESSES	OLD BLOCK	OLD LOT	NEW BLOCK	NEW LOT
103A & 103B DWIGHT STREET	1331	15	25804	7	125A & 125B DWIGHT STREET	1330	61	25704	17	140A & 140B STEGMAN STREET	1318	200	25001	42
107A & 107B DWIGHT STREET	1331	14	25804	6	176A & 176B DWIGHT STREET	1326	100	25101	38	146 STEGMAN STREET	1318	197	25001	45
109A & 109B DWIGHT STREET	1331	13	25804	5						148 STEGMAN STREET	1318	190	25101	46



PROJECT N.J. 9-10
 DWIGHT STREET HOMES
 JERSEY CITY, NJ 07305

SITE PLAN
 REVISED: 02/2020



ERIE ST

FIFTH ST

COMMUNITY
ROOM

MANAGER'S
OFFICE

PARKING

PARKING

88-92 ERIE STREET

SITE AREA	0.23 AC
BLDG. AREA*	6,835 SF
TOTAL # OF DWELLING UNITS	48
TOTAL # OF NON-DWELLING UNITS	0

*GROSS FIRST FLOOR AREA

OLD TAX BLOCK: 247 LOT: T,R,V2

WARD E: Downtown
ZONE: Harsimus Cove Historic District

Affordable Housing Communities

- **254 Bergen Avenue**
- **Arlington Gardens**

BERGEN AVENUE

GRANT STREET

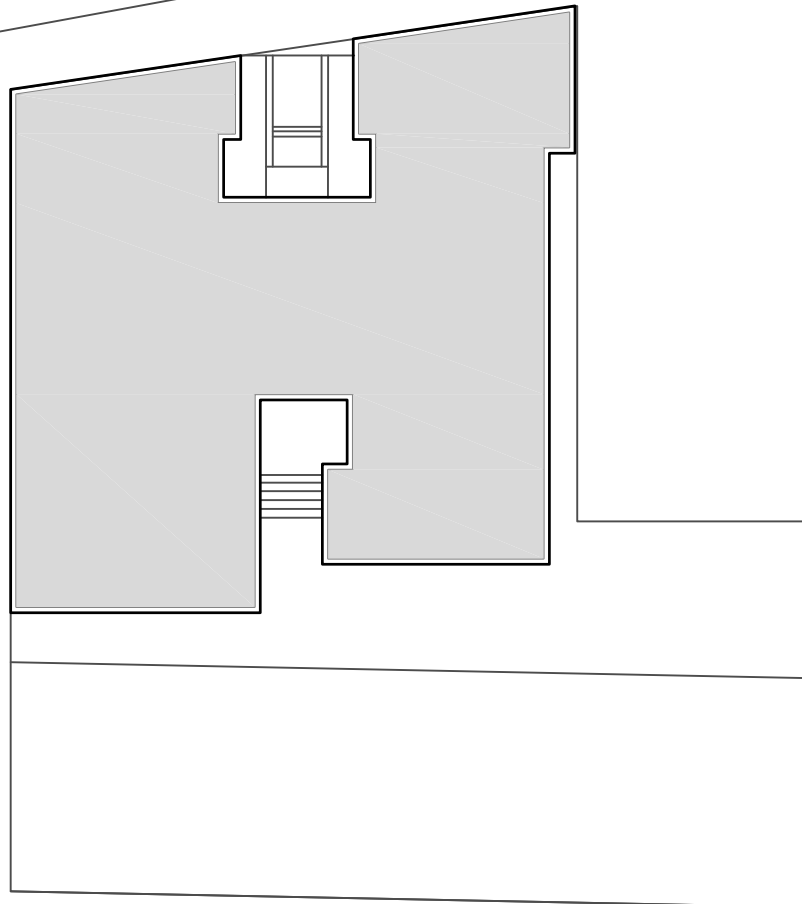

254 BERGEN AVENUE	
SITE AREA	0.27 AC
BLDG. AREA*	8,000 SF
TOTAL # OF DWELLING UNITS	36
TOTAL # OF NON-DWELLING UNITS	0

*GROSS FIRST FLOOR AREA

OLD TAX BLOCK: 1985 LOT: L16

WARD F: Bergen Lafayette
ZONE: R-3 Multi-Family Mid-Rise



BLDG. #	ADDRESSES	BLDG. AREA*	# OF UNITS
BUILDING 1	301, 311 RANDOLPH AVENUE	5,314 SF	18
BUILDING 2	305, 309 RANDOLPH AVENUE	5,314 SF	18
BUILDING 3	380, 382 ARLINGTON AVENUE	5,314 SF	18
BUILDING 4	388, 390 ARLINGTON AVENUE	5,314 SF	18
BUILDING 5	315, 325 RANDOLPH AVENUE	5,314 SF	18
TOTALS		26,570 SF	90
TOTAL # OF DWELLING UNITS			90
TOTAL # OF NON-DWELLING UNITS			0

*GROSS FIRST FLOOR AREA

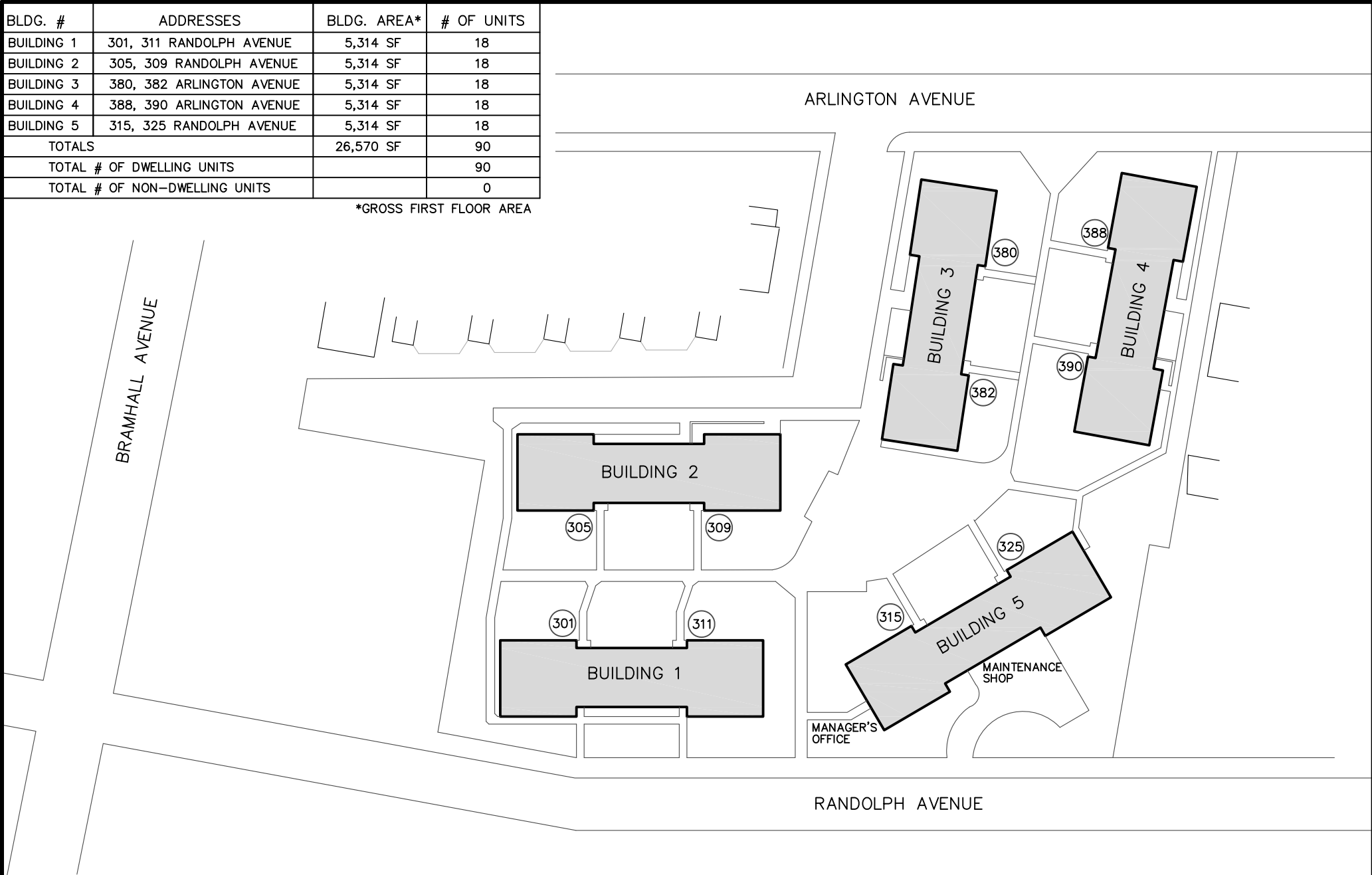

WARD F: Bergen Lafayette
ZONE: R-1 One and Two Family Housing

SITE AREA: 2.45 AC
OLD TAX BLOCK: 1946 LOT: A



AFFORDABLE HOUSING
ARLINGTON GARDENS
JERSEY CITY, NJ 07304

SITE PLAN
BLOCK: 18803 LOT: 11
REVISED: 02/2020

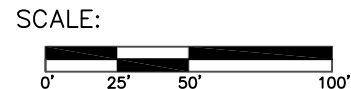

Mixed Finance/Mixed Income Communities

McCormack Baron Ragan, Property Manager

- N.J. 9-12, Lafayette Village

The Michaels Organization, Property Manager

- N.J. 9-13, Lafayette Senior Living Center
- N.J. 9-14, Pacific Court
- N.J. 9-15, Woodward Terrace
- N.J. 9-18, Barbara Place Terrace
- N.J. 9-20, Ocean Pointe East & West
- N.J. 9-21, Glennview Townhouses Phase I
- N.J. 9-23, Glennview Townhouses Phase II—East
- N.J. 9-25, Glennview Townhouses Phase II—West
- Catherine Todd Senior Living Center
- N.J. 9-26, Montgomery Family Phase I a.k.a. Mill Creek Gardens

Ingerman Management Corporation, Property Manager

- N.J. 9-17, Gloria Robinson Court Homes Phase I
- N.J. 9-19, Gloria Robinson Court Homes Phase II

Pennrose Management Company, Property Manager

- N.J. 9-22, Gloria Robinson Court Homes Phase III
- N.J. 9-24, Gloria Robinson Court Homes Phase IV

BLDG. #	NEW BLOCK #	NEW LOT #	OLD BLOCK #	OLD LOT #	SITE AREA	BLDG. AREA*	# OF UNITS
BUILDINGS 1 – 12	15502	1	2086	39	2.09 AC	25,316 SF	44
BUILDING 34	"	"	"	"	"	2,935 SF	0
BUILDINGS 13 – 21	15503	1	2087.1	2	1.74 AC	25,501 SF	47
BUILDINGS 22 – 33	15502	2	2087.1	1	1.96 AC	18,491 SF	33
TOTAL					5.79 AC	72,243 SF	124
						TOTAL # OF ACC UNITS	77

*GROSS FIRST FLOOR AREA

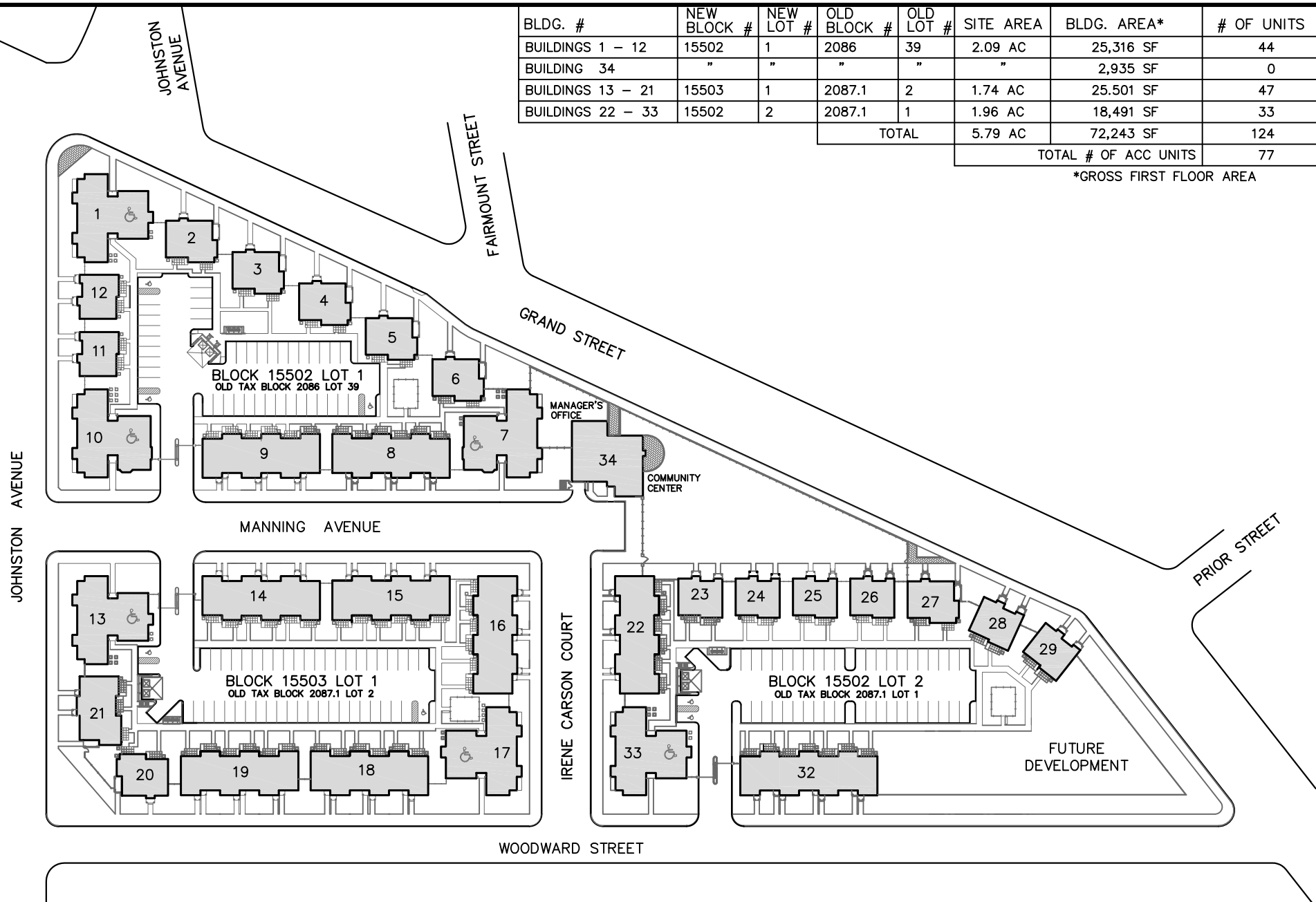

WARD F: Bergen Lafayette
ZONE: Lafayette Park

BLDG. #	ADDRESSES	BLDG. AREA*	# OF UNITS
BUILDING 1	601, 603, 605, 607, 609, 611 GRAND STREET	3,128 SF	6
BUILDING 2	597, 599 GRAND STREET	1,346 SF	2
BUILDING 3	593, 595 GRAND STREET	1,346 SF	2
BUILDING 4	589, 591 GRAND STREET	1,346 SF	2
BUILDING 5	585, 587 GRAND STREET	1,346 SF	2
BUILDING 6	581, 583 GRAND STREET	1,346 SF	2
BUILDING 7	135, 137, 139, 141, 143, 145 MANNING AVENUE	3,342 SF	6
BUILDING 8	123, 125, 127, 129, 131, 133 MANNING AVENUE	3,214 SF	6
BUILDING 9	111, 113, 115, 117, 119, 121 MANNING AVENUE	3,214 SF	6
BUILDING 10	93, 95, 97, 99, 101, 103 MANNING AVENUE	3,342 SF	6
BUILDING 11	434, 436 JOHNSTON AVENUE	1,173 SF	2
BUILDING 12	438, 440 JOHNSTON AVENUE	1,173 SF	2
BUILDING 34	579 GRAND STREET (MANAGEMENT BLDG.)	2,935 SF	0
TOTALS (THIS BLOCK)		25,316 SF	44

*GROSS FIRST FLOOR AREA

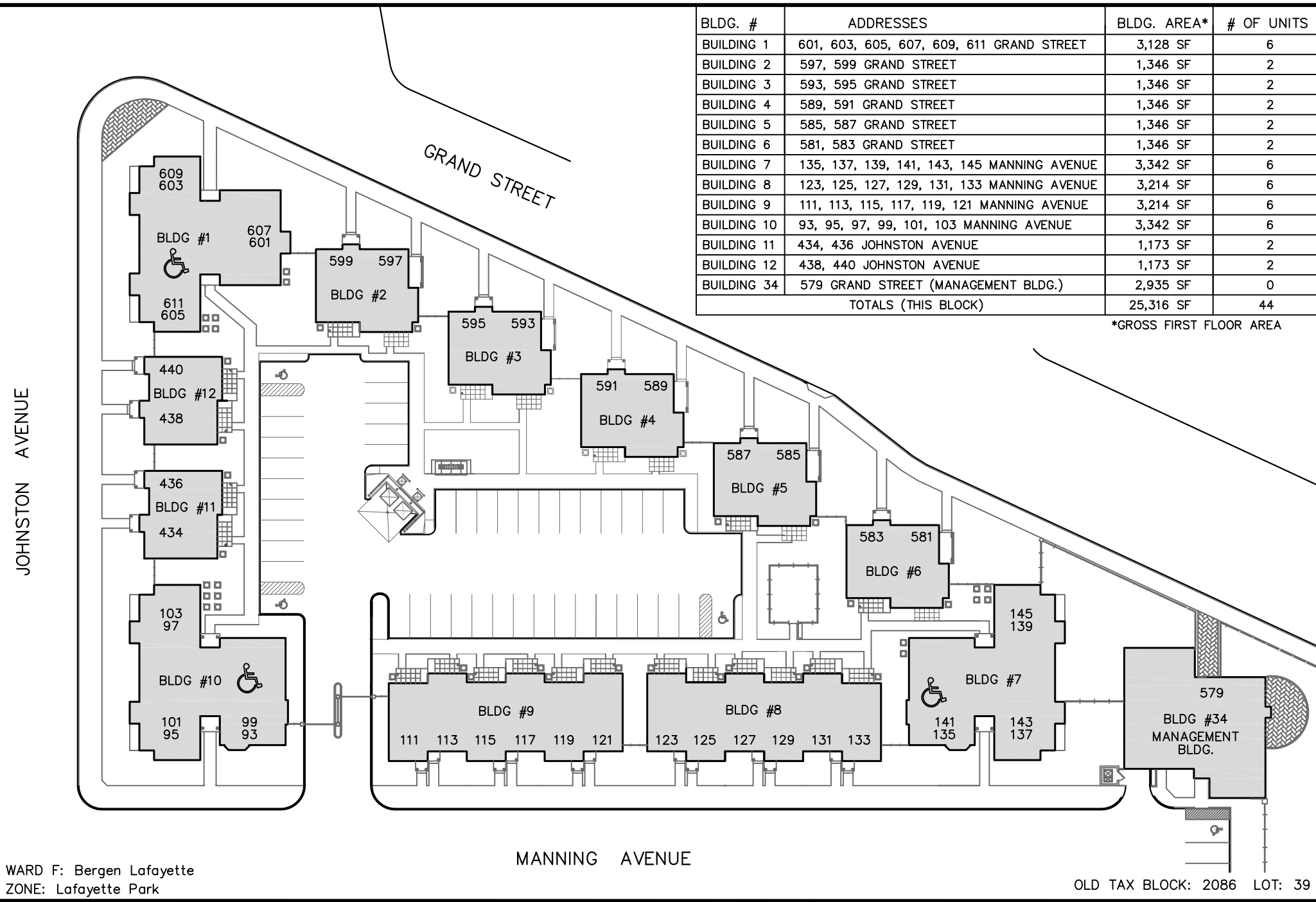

WARD F: Bergen Lafayette
ZONE: Lafayette Park

OLD TAX BLOCK: 2086 LOT: 39



PROJECT N.J. 9-12
LAFAYETTE VILLAGE
JERSEY CITY, NJ 07304

SITE PLAN
BLOCK: 15502 LOT: 1
REVISED: 02/2020
PAGE 2 of 4

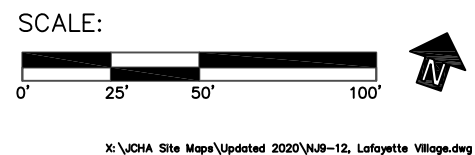

X:\JCHA Site Maps\Updated 2020\NJ9-12, Lafayette Village.dwg

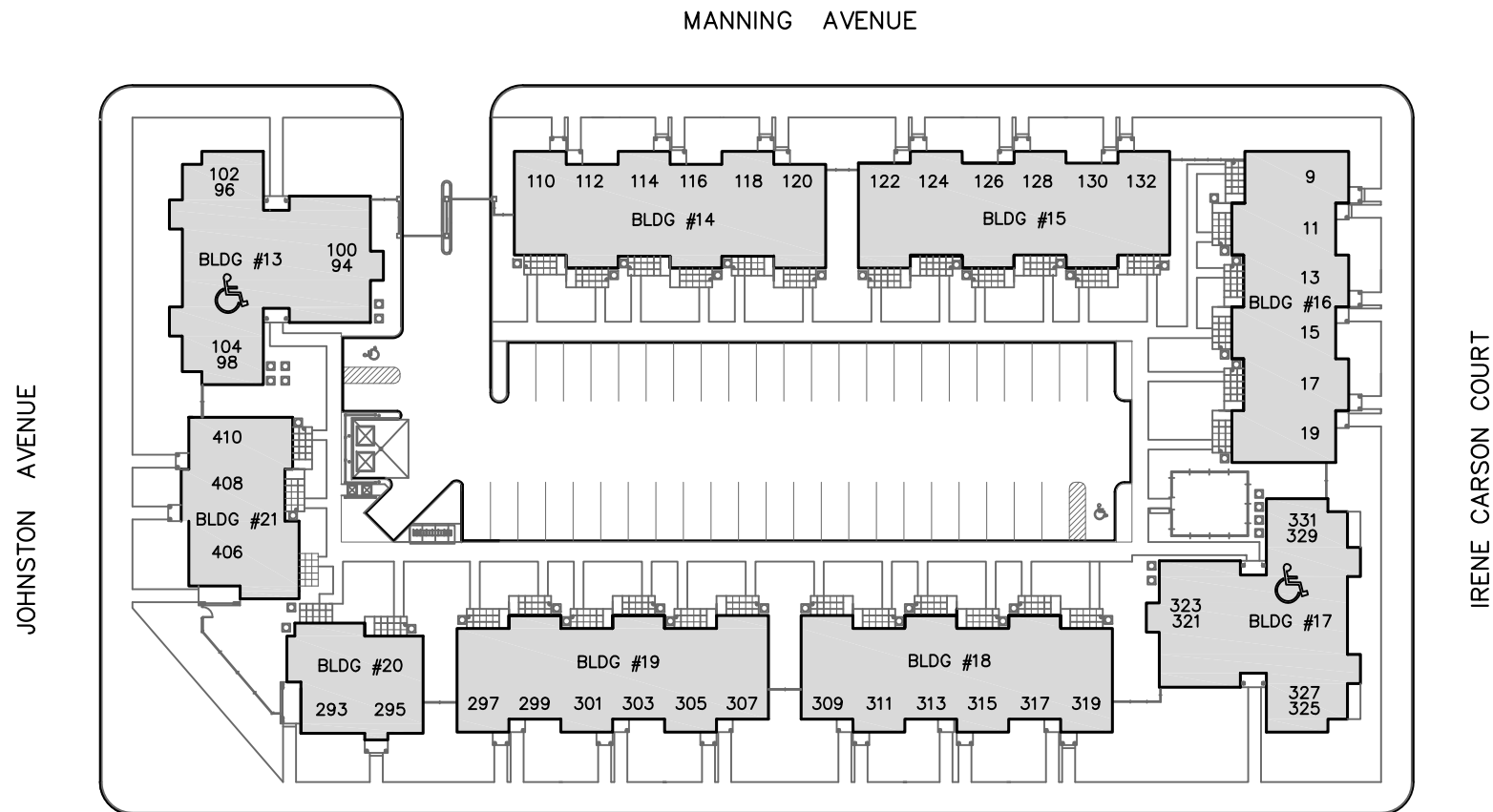

BLDG. #	ADDRESSES	BLDG. AREA*	# OF UNITS
BUILDING 13	94, 96, 98, 100, 102, 104 MANNING AVENUE	3,128 SF	6
BUILDING 14	110, 112, 114, 116, 118, 120 MANNING AVENUE	3,214 SF	6
BUILDING 15	122, 124, 126, 128, 130, 132 MANNING AVENUE	3,214 SF	6
BUILDING 16	9, 11, 13, 15, 17, 19 IRENE CARSON COURT	3,214 SF	6
BUILDING 17	321, 323, 325, 327, 329, 331 WOODWARD STREET	3,128 SF	6
BUILDING 18	309, 311, 313, 315, 317, 319 WOODWARD STREET	3,214 SF	6
BUILDING 19	297, 299, 301, 303, 305, 307 WOODWARD STREET	3,214 SF	6
BUILDING 20	293, 295 WOODWARD STREET	1,346 SF	2
BUILDING 21	406, 408, 410 JOHNSTON AVENUE	1,829 SF	3
TOTALS (THIS BLOCK)		25,501 SF	47

*GROSS FIRST FLOOR AREA

WOODWARD STREET

OLD TAX BLOCK: 2087.1 LOT: 2

BLDG. #	ADDRESSES	BLDG. AREA*	# OF UNITS
BUILDING 22	10, 12, 14, 16, 18, 20 IRENE CARSON COURT	3,214 SF	6
BUILDING 23	575, 577 GRAND STREET	1,173 SF	2
BUILDING 24	571, 573 GRAND STREET	1,173 SF	2
BUILDING 25	567, 569 GRAND STREET	1,173 SF	2
BUILDING 26	563, 565 GRAND STREET	1,173 SF	2
BUILDING 27	559, 561 GRAND STREET	1,346 SF	2
BUILDING 28	555, 557 GRAND STREET	1,173 SF	2
BUILDING 29	551, 553 GRAND STREET	1,173 SF	2
BUILDING 32	351, 353, 355, 357, 359, 361, 363 WOODWARD STREET	3,765 SF	7
BUILDING 33	337, 339, 341, 343, 345, 347 WOODWARD STREET	3,128 SF	6
TOTALS (THIS BLOCK)		18,491 SF	33

*GROSS FIRST FLOOR AREA

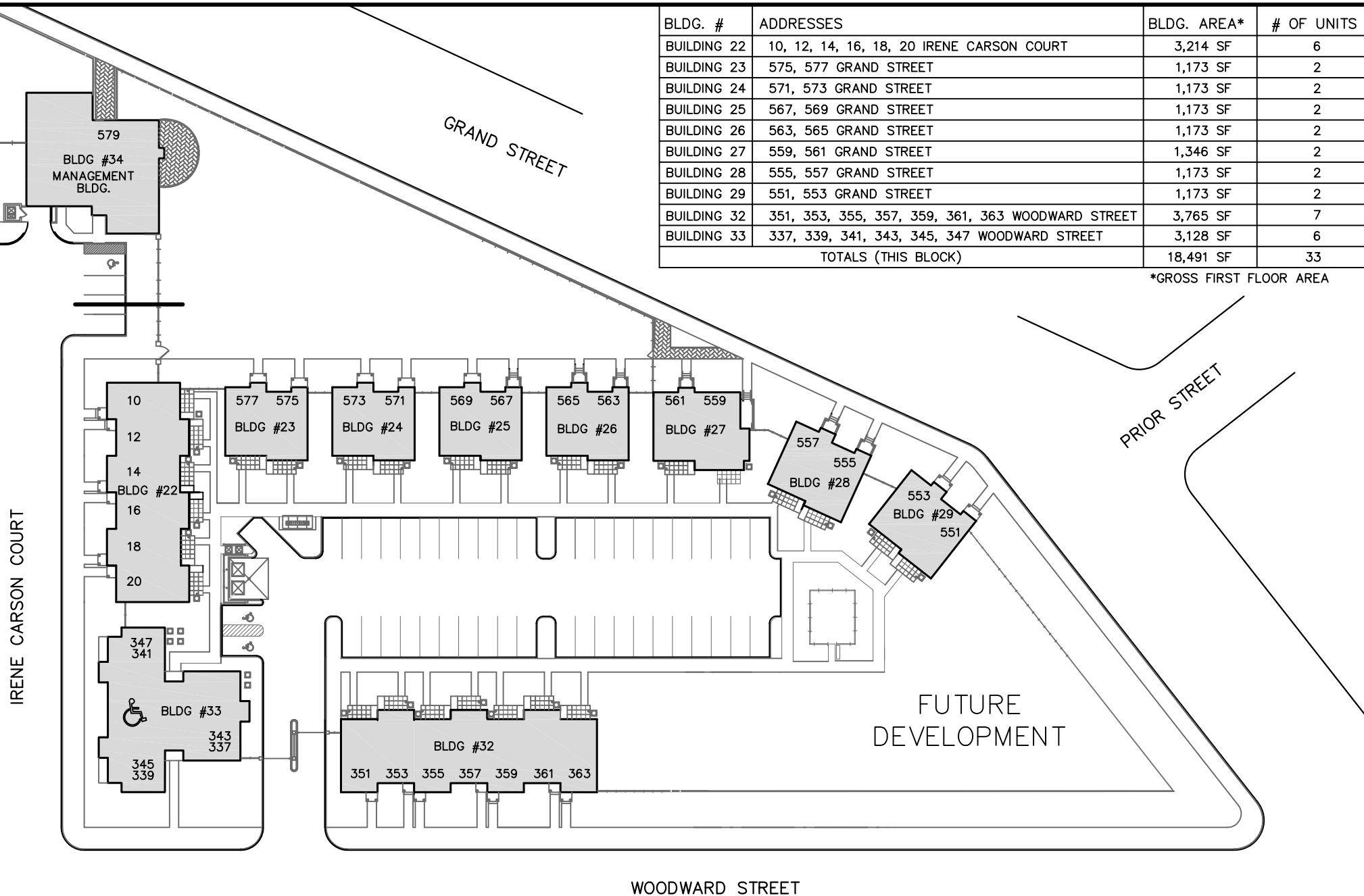

WARD F: Bergen Lafayette
ZONE: Lafayette Park

OLD TAX BLOCK: 2086 LOT: 39

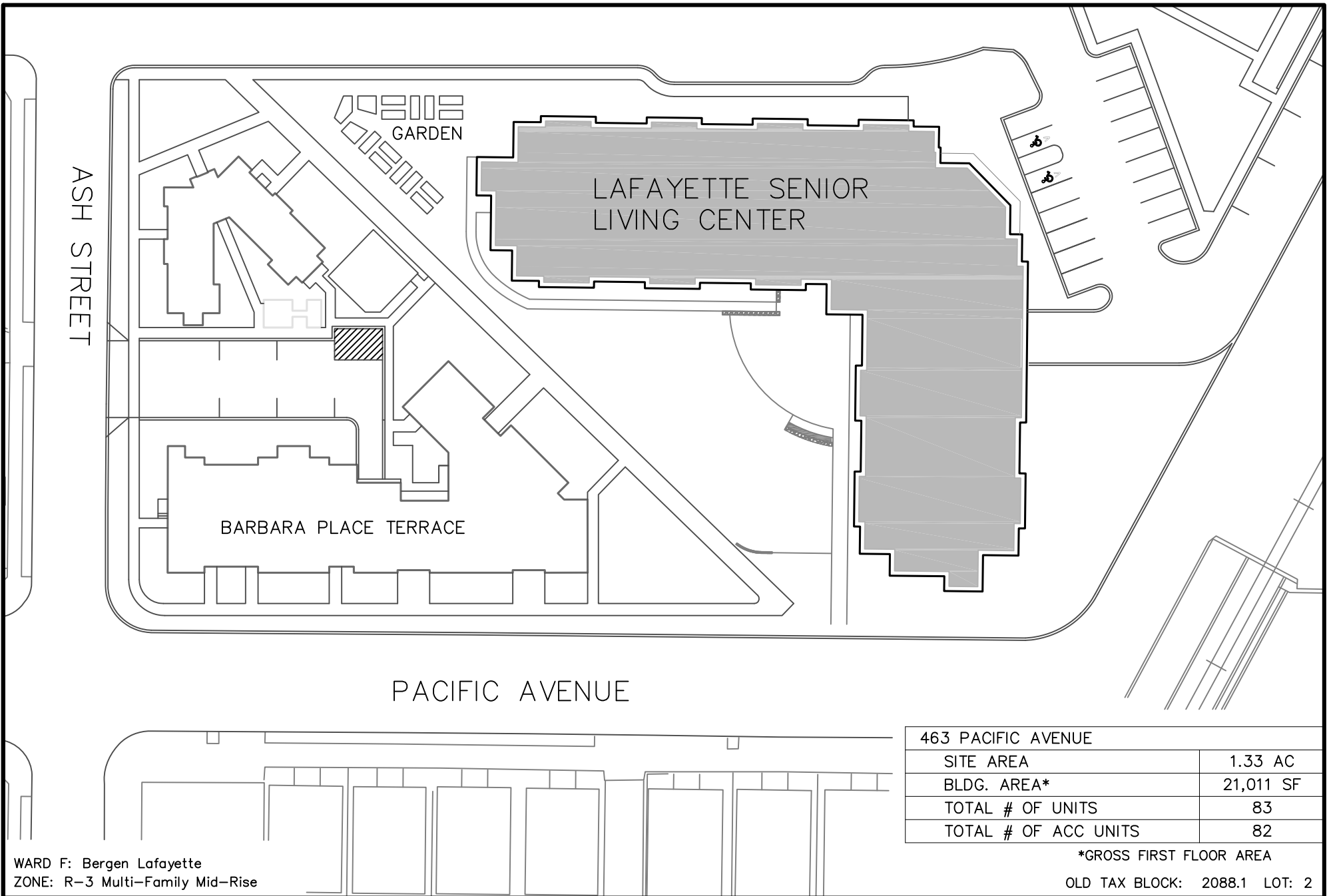

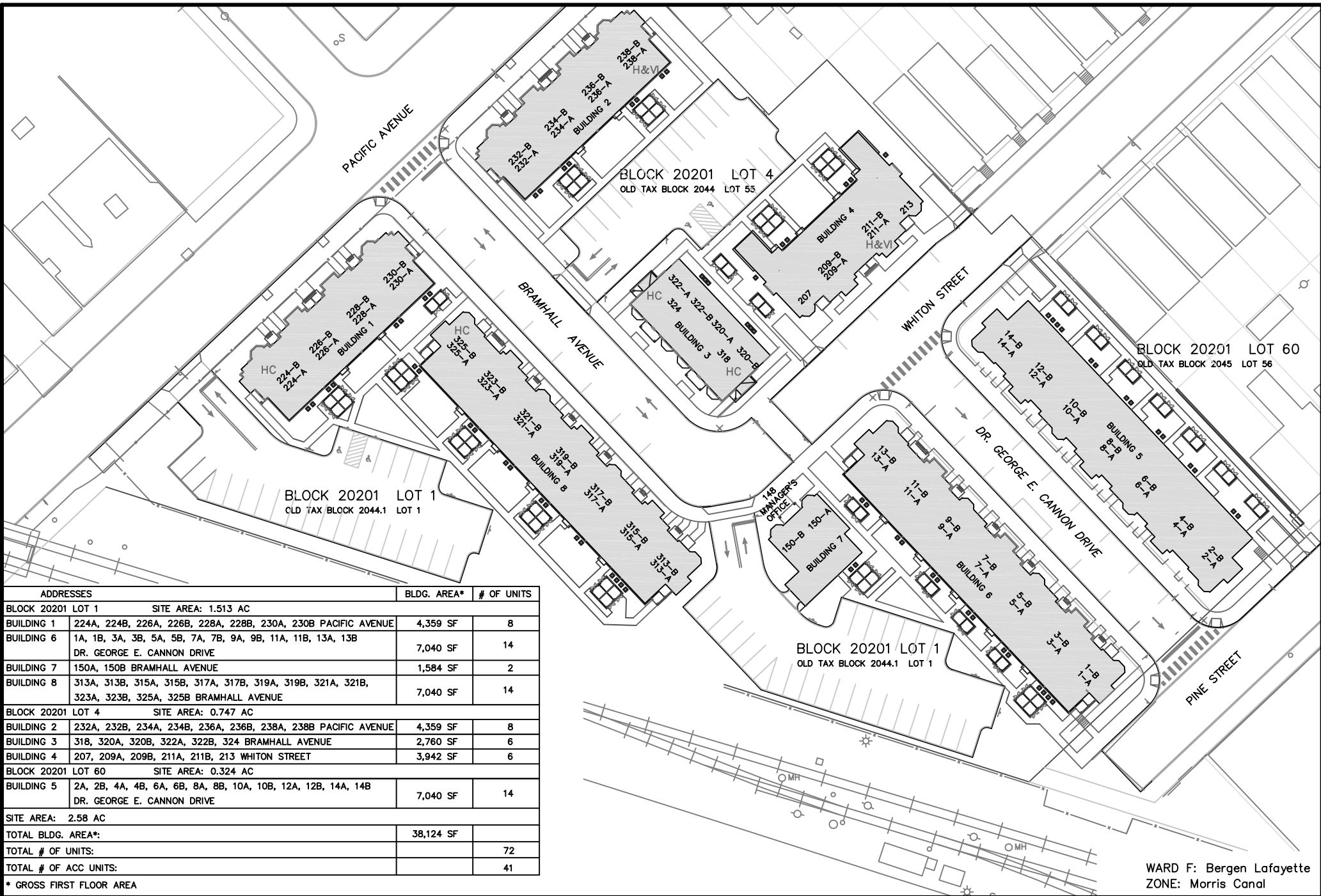

ADDRESSES		BLDG. AREA*	# OF UNITS
BLOCK 20201 LOT 1		SITE AREA: 1.513 AC	
BUILDING 1	224A, 224B, 226A, 226B, 228A, 228B, 230A, 230B PACIFIC AVENUE	4,359 SF	8
BUILDING 6	1A, 1B, 3A, 3B, 5A, 5B, 7A, 7B, 9A, 9B, 11A, 11B, 13A, 13B DR. GEORGE E. CANNON DRIVE	7,040 SF	14
BUILDING 7	150A, 150B BRAMHALL AVENUE	1,584 SF	2
BUILDING 8	313A, 313B, 315A, 315B, 317A, 317B, 319A, 319B, 321A, 321B, 323A, 323B, 325A, 325B BRAMHALL AVENUE	7,040 SF	14
BLOCK 20201 LOT 4		SITE AREA: 0.747 AC	
BUILDING 2	232A, 232B, 234A, 234B, 236A, 236B, 238A, 238B PACIFIC AVENUE	4,359 SF	8
BUILDING 3	318, 320A, 320B, 322A, 322B, 324 BRAMHALL AVENUE	2,760 SF	6
BUILDING 4	207, 209A, 209B, 211A, 211B, 213 WHITON STREET	3,942 SF	6
BLOCK 20201 LOT 60		SITE AREA: 0.324 AC	
BUILDING 5	2A, 2B, 4A, 4B, 6A, 6B, 8A, 8B, 10A, 10B, 12A, 12B, 14A, 14B DR. GEORGE E. CANNON DRIVE	7,040 SF	14
SITE AREA: 2.58 AC			
TOTAL BLDG. AREA*:		38,124 SF	
TOTAL # OF UNITS:			72
TOTAL # OF ACC UNITS:			41

* GROSS FIRST FLOOR AREA

WARD F: Bergen Lafayette
ZONE: Morris Canal



PROJECT N.J. 9-14
PACIFIC COURT
JERSEY CITY, NJ 07304

SITE PLAN

REVISED: 02/2020

SCALE:

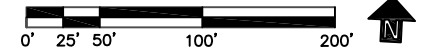

X:\JCHA Site Maps\Updated 2020\NJ 9-14, Pacific Court.dwg

LAFAYETTE VILLAGE

WOODWARD STREET

JAMES "POP" CURRY DRIVE

WALTER MAYS DRIVE

VAN HORNE STREET

CARBON

BUILDING 1	302-1 WOODWARD STREET 16-2, 14-2, 14-1, 12-2, 12-1, 10-2, 10-1, 8-2, 8-1, 6-2, 6-1, 4-2 JAMES "POP" CURRY DRIVE 345-1 VAN HORNE STREET	BUILDING 2	312-1, 312-2, 312-3, 314-2, 314-1, 316-2, 316-1, 318-2, 318-1, 320-2, 320-1, 322-2, 322-1, 324 WOODWARD STREET	BUILDING 3	351, 353-2, 353-1, 355-2, 355-1, 357-2, 357-1, 359-2, 359-1, 361-2, 361-1, 363-3, 363-2, 363-1 VAN HORNE STREET
14 UNITS		14 UNITS		14 UNITS	
7,669 SF*		7,579 SF*		7,579 SF*	
BUILDING 4	322-1 WOODWARD STREET 15-2, 13-2, 13-1, 11-2, 11-1, 9-2, 9-1, 7-2, 7-1, 5-2, 5-1, 3-2 WALTER MAYS DRIVE 377-1 VAN HORNE STREET	BUILDING 5	334-1 WOODWARD STREET 16-2, 14-2, 14-1, 12-2, 12-1, 10-2, 10-1, 8-2, 8-1, 6-2, 6-1, 4-2 WALTER MAYS DRIVE 379-1 VAN HORNE STREET	SITE AREA: 2.31 AC TOTAL BLDG. AREA*: 38,165 SF TOTAL # OF UNITS: 70 TOTAL # OF ACC UNITS: 45	
14 UNITS		14 UNITS			
7,669 SF*		7,669 SF*			

WARD F: Bergen Lafayette
ZONE: R-3 Multi-Family Mid-Rise

*GROSS FIRST FLOOR AREA
OLD TAX BLOCK: 2088 LOT: 1.2



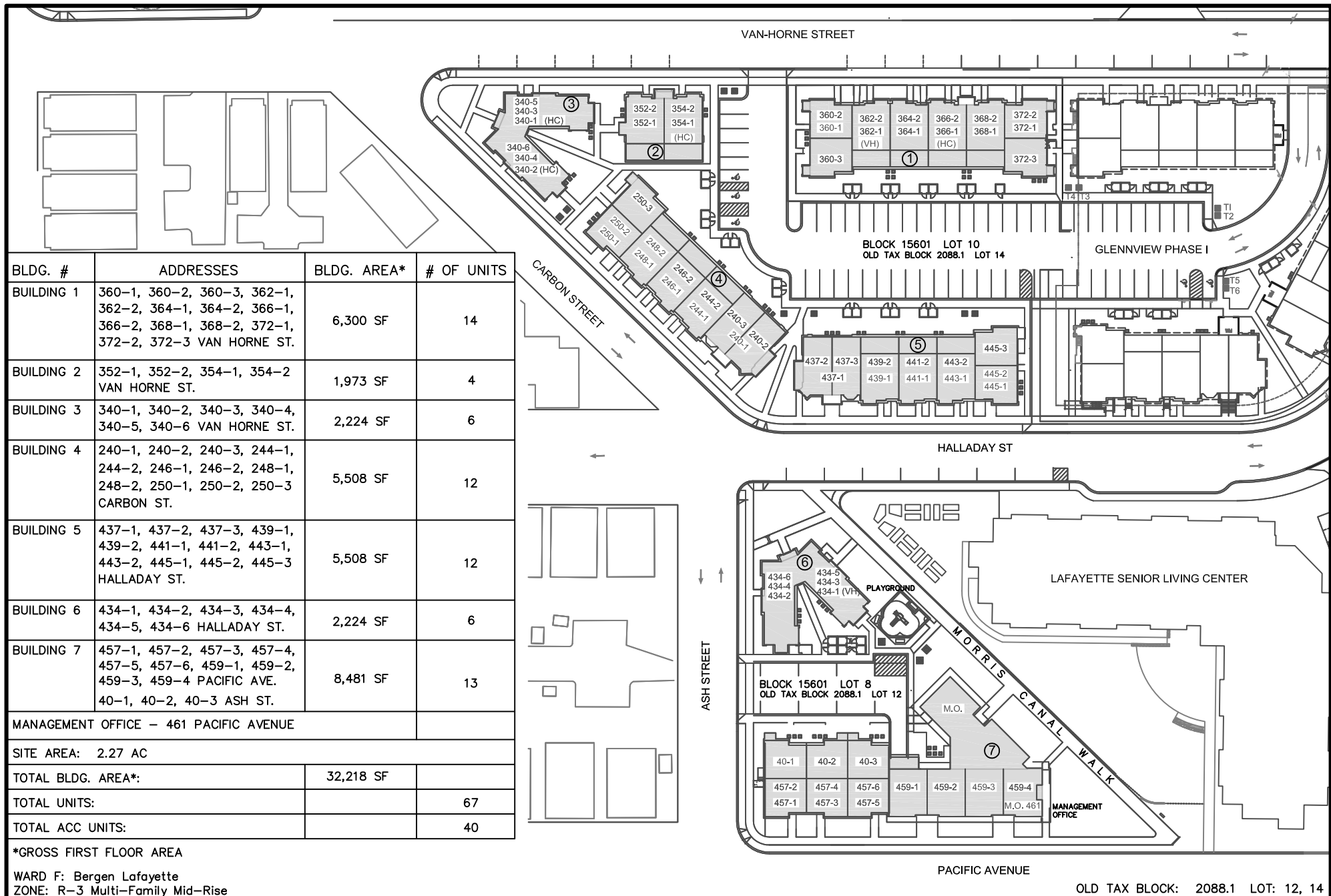

460 OCEAN AVENUE – EAST
 WARD A: Greenville
 ZONE: Ocean/Bayview

461 OCEAN AVENUE – WEST
 WARD F: Bergen Lafayette
 ZONE: Turnkey

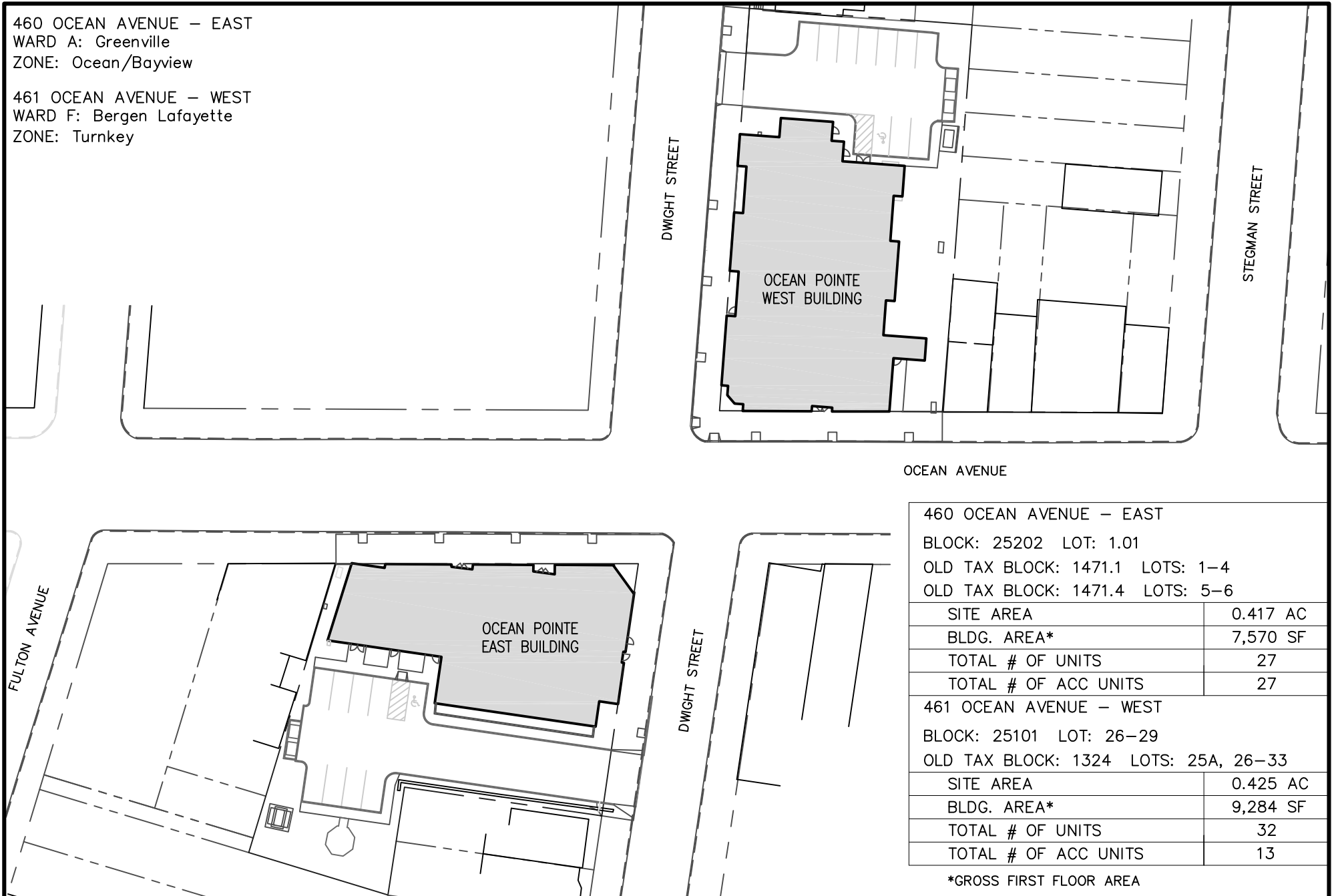

460 OCEAN AVENUE – EAST

BLOCK: 25202 LOT: 1.01

OLD TAX BLOCK: 1471.1 LOTS: 1–4

OLD TAX BLOCK: 1471.4 LOTS: 5–6

SITE AREA	0.417 AC
BLDG. AREA*	7,570 SF
TOTAL # OF UNITS	27
TOTAL # OF ACC UNITS	27

461 OCEAN AVENUE – WEST

BLOCK: 25101 LOT: 26–29

OLD TAX BLOCK: 1324 LOTS: 25A, 26–33

SITE AREA	0.425 AC
BLDG. AREA*	9,284 SF
TOTAL # OF UNITS	32
TOTAL # OF ACC UNITS	13

*GROSS FIRST FLOOR AREA



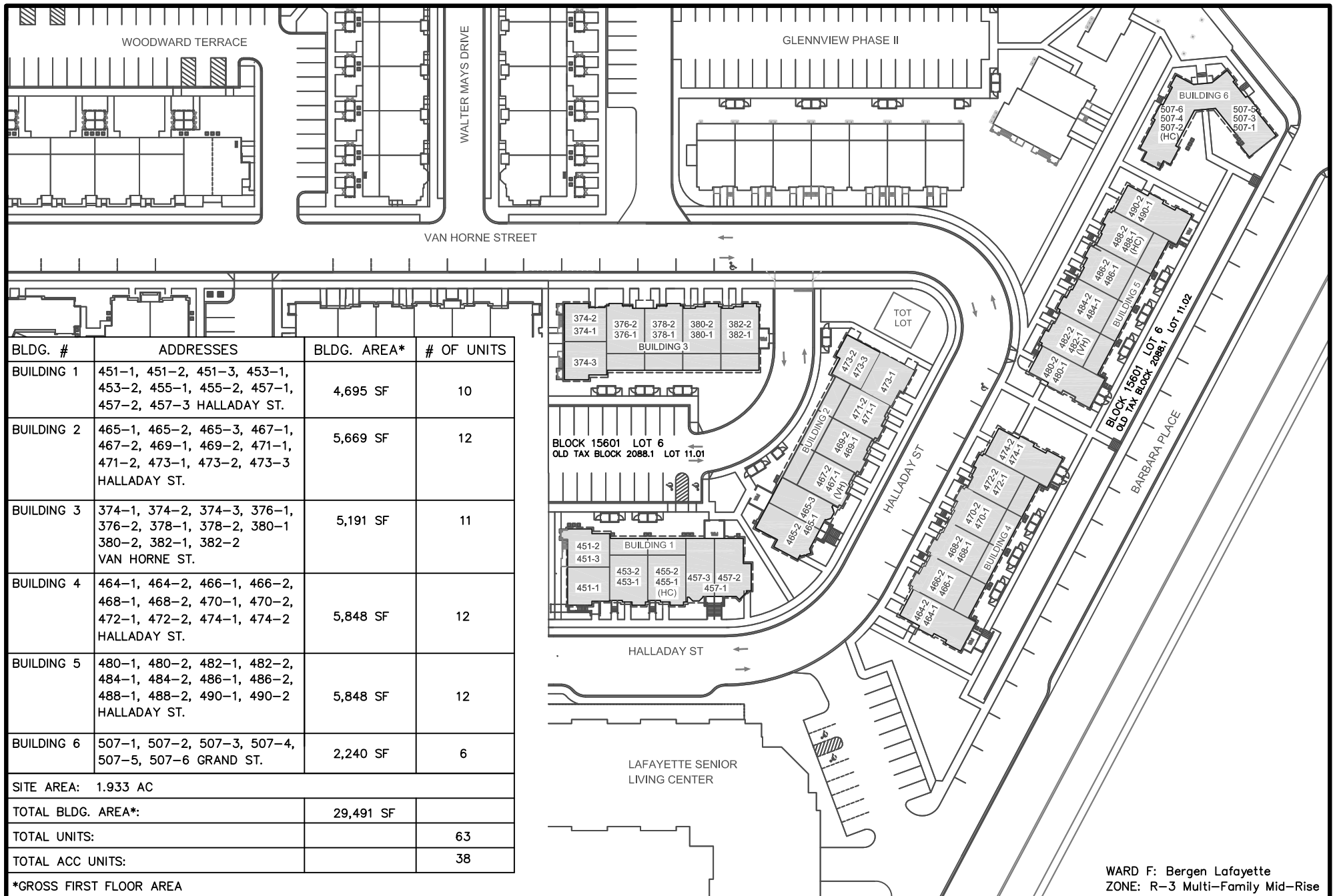

WARD F: Bergen Lafayette
ZONE: R-3 Multi-Family Mid-Rise



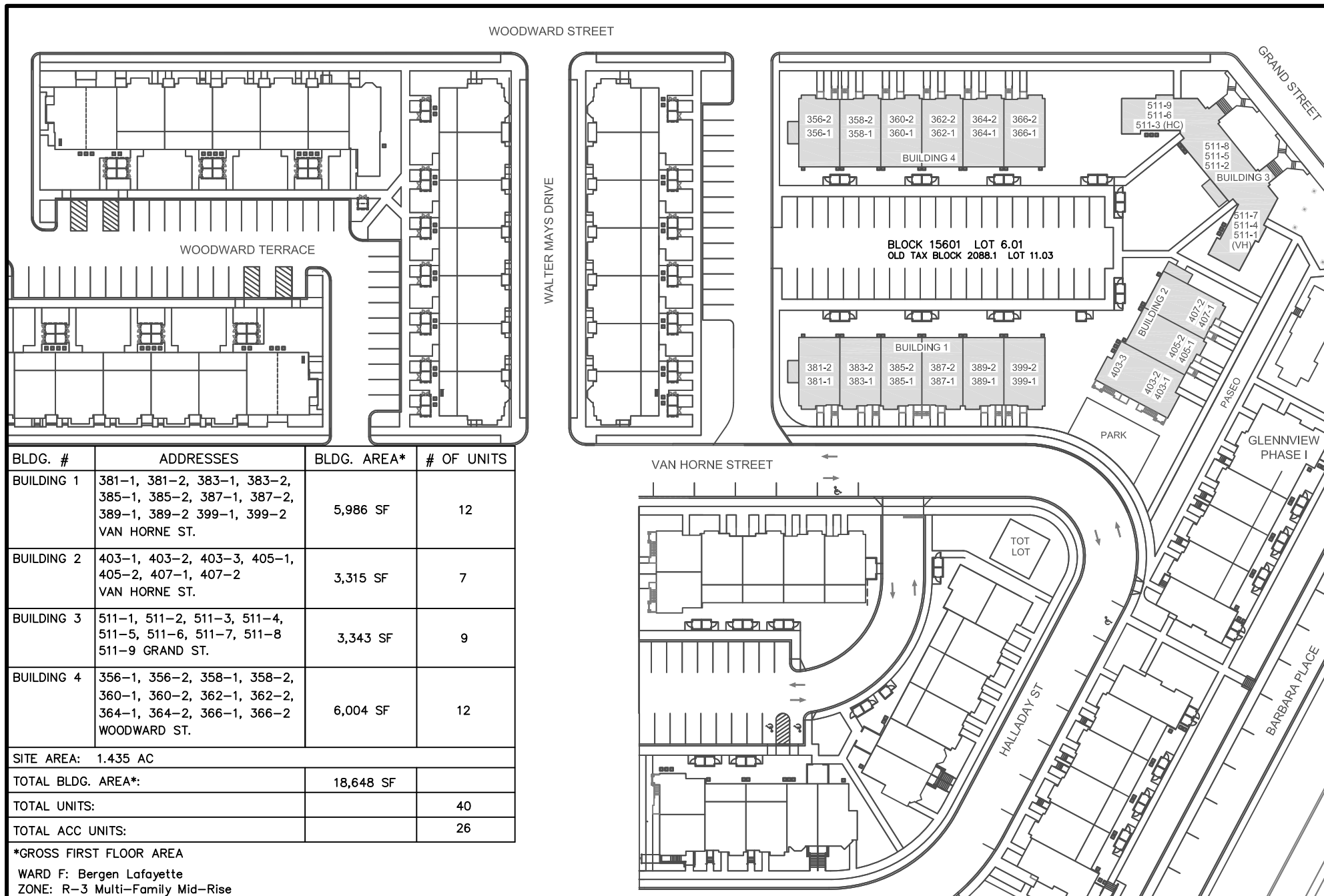

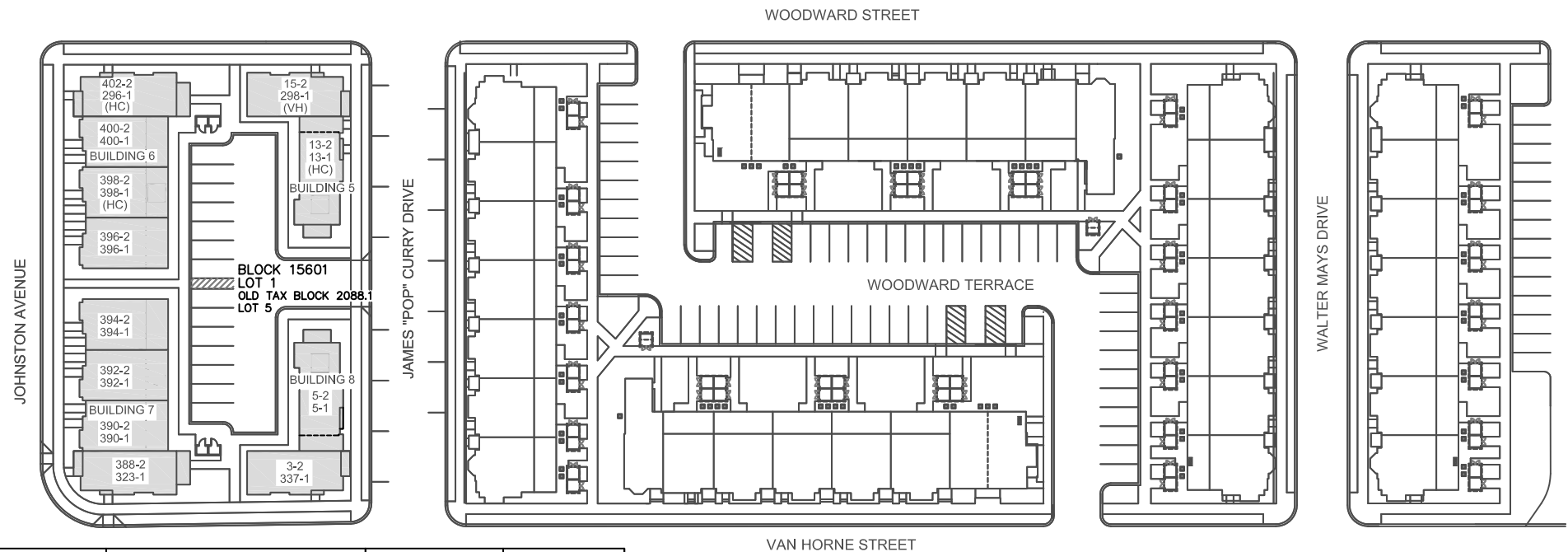

BLDG. #	ADDRESSES	BLDG. AREA*	# OF UNITS
BUILDING 5	13-1, 13-2, 15-2 JAMES POP CURRY DR. 298-1 WOODWARD ST.	2,060 SF	4
BUILDING 6	296-1 WOODWARD ST. 396-1, 396-2, 398-1, 398-2 400-1, 400-2, 402-2 JOHNSTON AVE.	3,941 SF	8
BUILDING 7	323-1 VAN HORNE ST. 388-2, 390-1, 390-2, 392-1 392-2, 394-1, 394-2 JOHNSTON AVE.	3,941 SF	8
BUILDING 8	3-2, 5-1, 5-2 JAMES CURRY POP DR. 337-1 VAN HORNE ST.	2,060 SF	4
SITE AREA: 0.59 AC			
TOTAL BLDG. AREA*:		12,002 SF	
TOTAL UNITS:			24
TOTAL ACC UNITS:			12

*GROSS FIRST FLOOR AREA



PROJECT N.J. 9-25
GLENNVIEW TOWNHOUSES
PHASE II - WEST
JERSEY CITY, NJ 07304

SITE PLAN

BLOCK: 15601 LOT: 1

REVISED: 02/2020

SCALE:

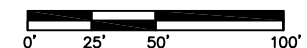

WARD F: Bergen Lafayette
ZONE: R-3 Multi-Family Mid-Rise

WARD F: Bergen Lafayette
ZONE: R-4 Multi-Family High-Rise

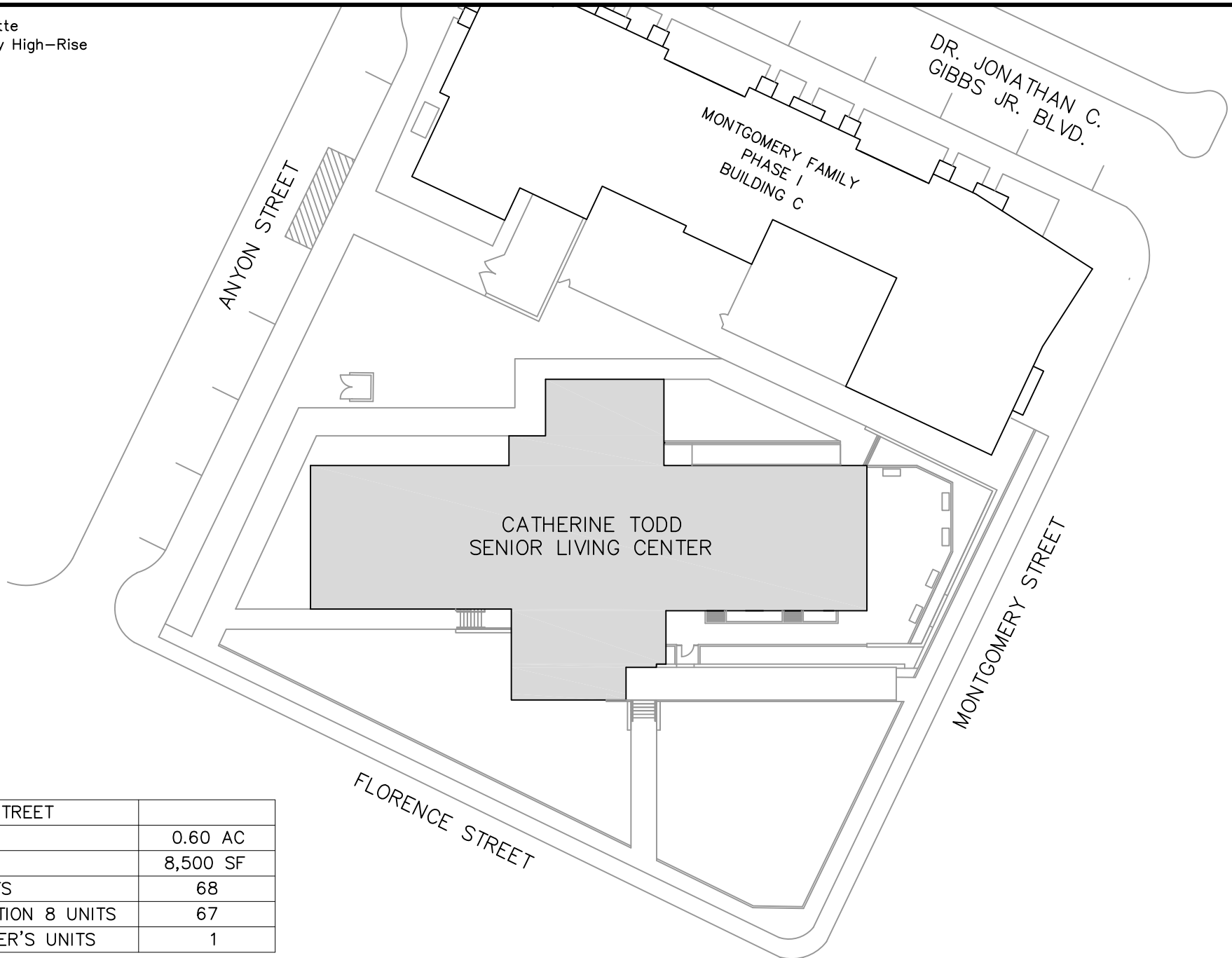

547 MONTGOMERY STREET	
SITE AREA	0.60 AC
BLDG. AREA*	8,500 SF
TOTAL # OF UNITS	68
TOTAL # OF SECTION 8 UNITS	67
TOTAL # OF SUPER'S UNITS	1

*GROSS FIRST FLOOR AREA

OLD TAX BLOCK: 2116 LOT: P

BLDG. #	ADDRESSES	BLDG. AREA*	# OF UNITS
BUILDING C	557 MONTGOMERY STREET	9,100 SF	21
BUILDING D	214 CORNELISON STREET	10,800 SF	28
BUILDING E	200 CORNELISON STREET	11,150 SF	36
BUILDING F	194 CORNELISON STREET	14,075 SF	41
SITE AREA: 1.4 AC			
TOTAL BLDG. AREA*:		45,125 SF	
TOTAL UNITS:			126

*GROSS FIRST FLOOR AREA

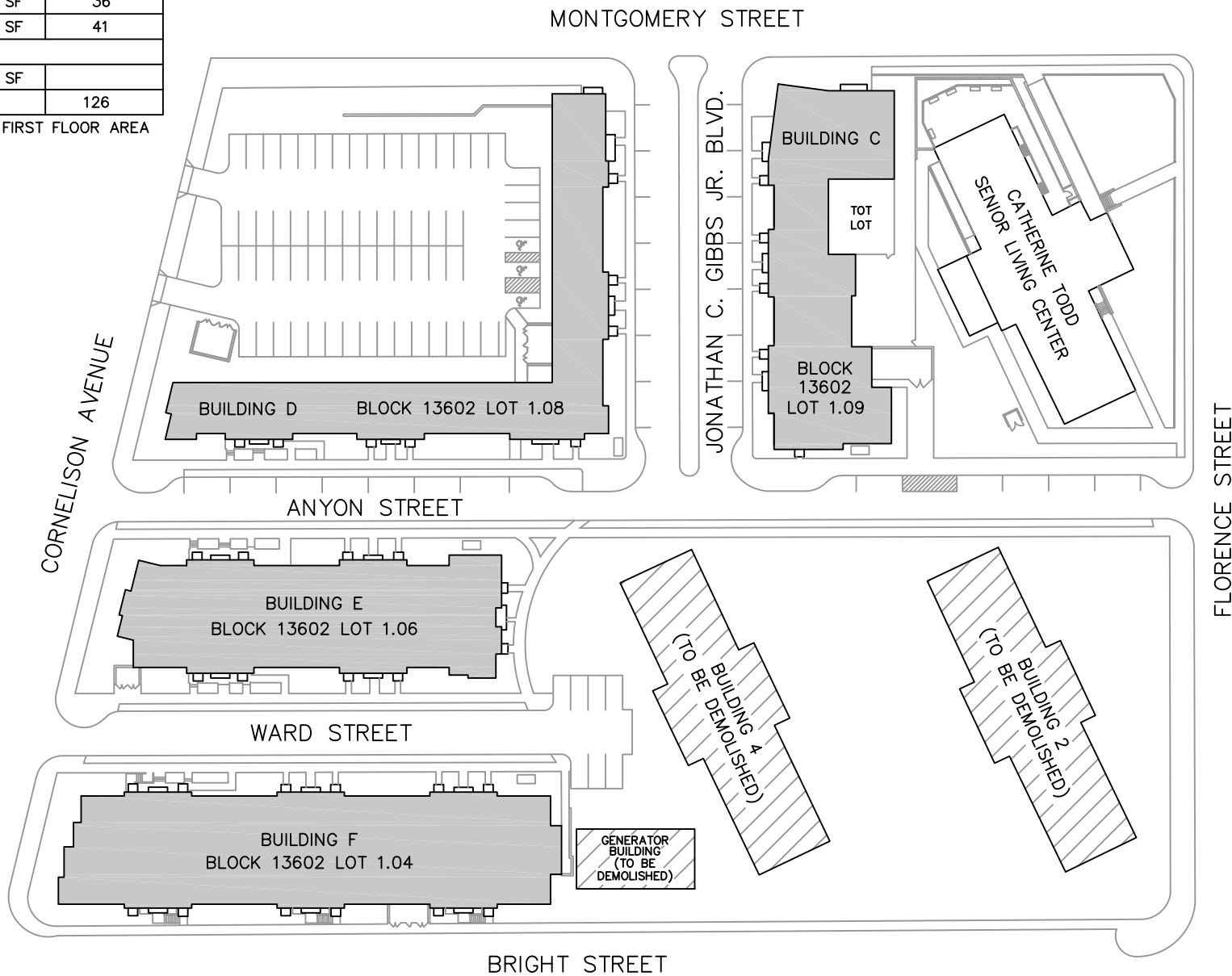

WARD F: Bergen Lafayette
 ZONE: R-4 Multi-Family High-Rise

OLD TAX BLOCK: 2116 LOT: P



BEDROOMS	BATHROOMS	# OF UNITS
1 BR	1 BATH	6
2 BR	1 BATH	11
3 BR	2 BATH	3
4 BR	2 BATH	1
TOTAL UNITS:		21
TOTAL BLDG. C AREA*:		15,612 SF
SITE AREA:		0.358 AC

*GROSS FIRST FLOOR AREA

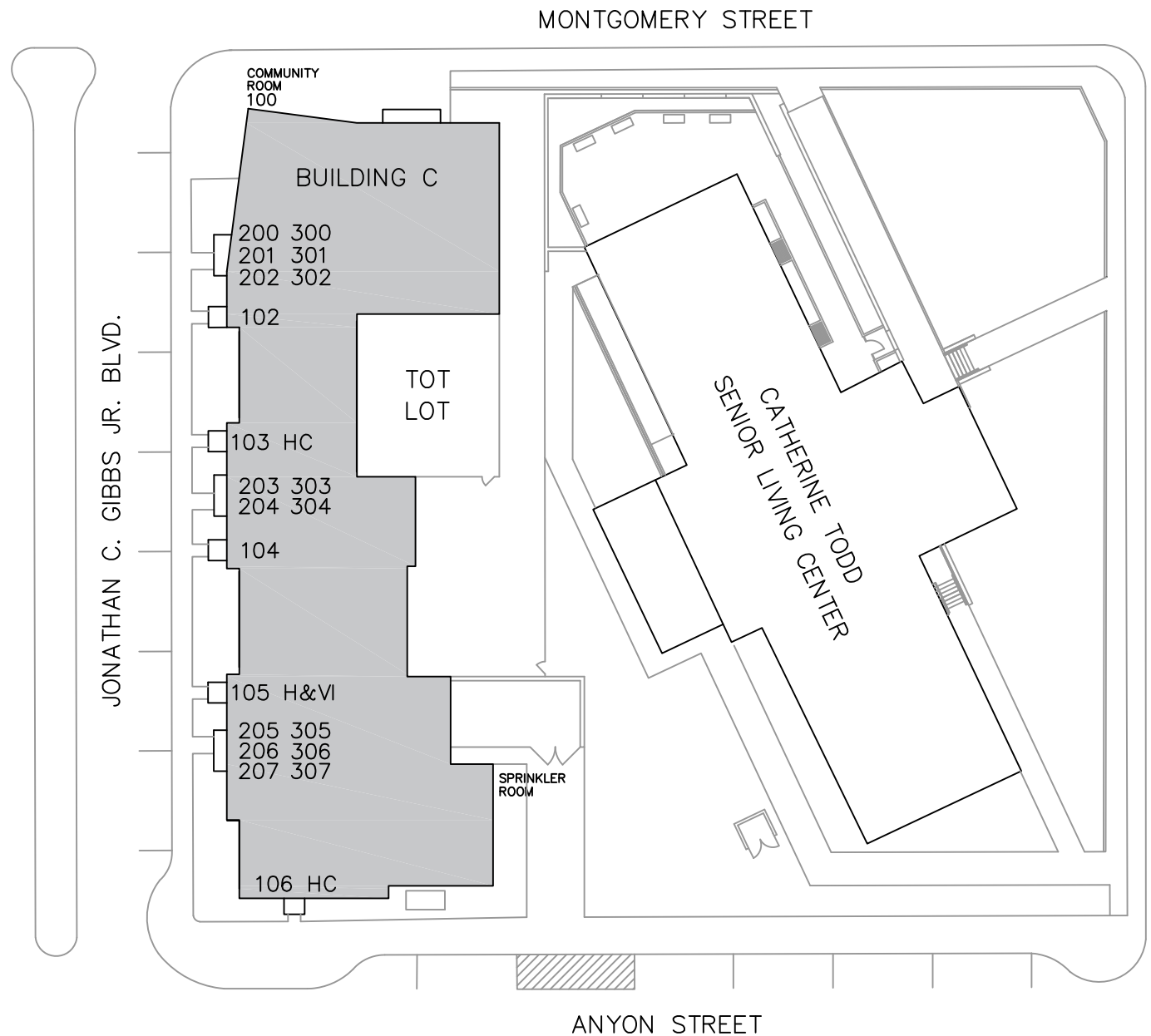

WARD F: Bergen Lafayette
ZONE: R-4 Multi-Family High-Rise

OLD TAX BLOCK: 2116 LOT: P



PROJECT N.J. 9-26
MONTGOMERY FAMILY PHASE I
A.K.A. MILL CREEK GARDENS
JERSEY CITY, NJ 07302

SITE PLAN
BLOCK: 13602 LOT: 1.09
REVISED: 02/2020
PAGE 2 OF 5

SCALE:
0' 10' 20' 40'



BEDROOMS	BATHROOMS	# OF UNITS
1 BR	1 BATH	11
2 BR	1 BATH	11
3 BR	1.5 BATH	3
3 BR	2 BATH	3
TOTAL UNITS:		28
TOTAL BLDG. D AREA*:		43,790 SF
SITE AREA:		1.004 AC

*GROSS FIRST FLOOR AREA

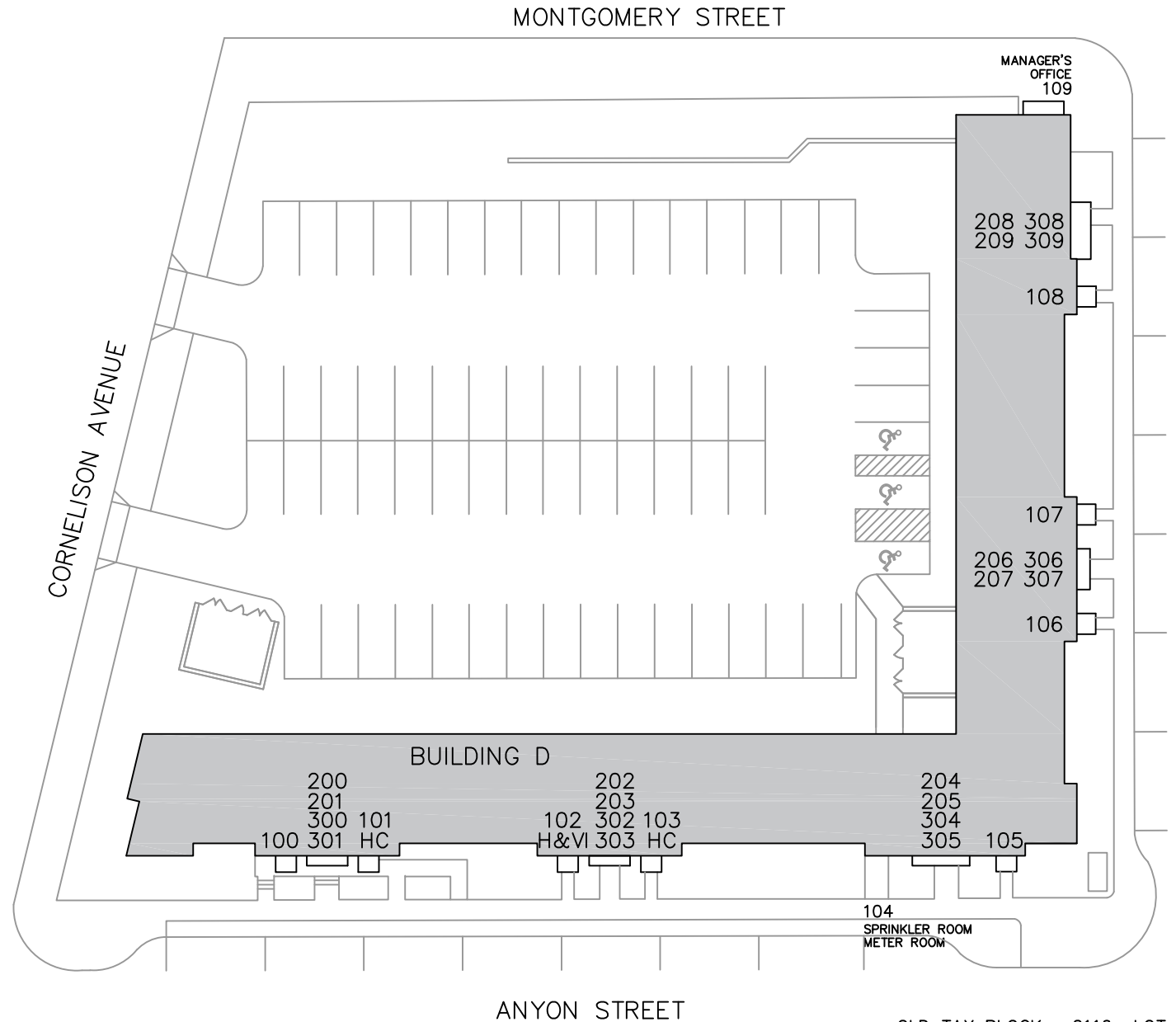

WARD F: Bergen Lafayette
ZONE: R-4 Multi-Family High-Rise

OLD TAX BLOCK: 2116 LOT: P



PROJECT N.J. 9-26
MONTGOMERY FAMILY PHASE I
A.K.A. MILL CREEK GARDENS
JERSEY CITY, NJ 07302

SITE PLAN
BLOCK: 13602 LOT: 1.08
REVISED: 02/2020
PAGE 3 OF 5

SCALE:
0' 10' 20' 40'



BEDROOMS	BATHROOMS	# OF UNITS
1 BR	1 BATH	4
2 BR	1 BATH	20
3 BR	1.5 BATH	1
3 BR	2 BATH	10
4 BR	2 BATH	1
TOTAL UNITS:		36
TOTAL BLDG. AREA*:		19,235 SF
SITE AREA: 0.442 AC		
*GROSS FIRST FLOOR AREA		

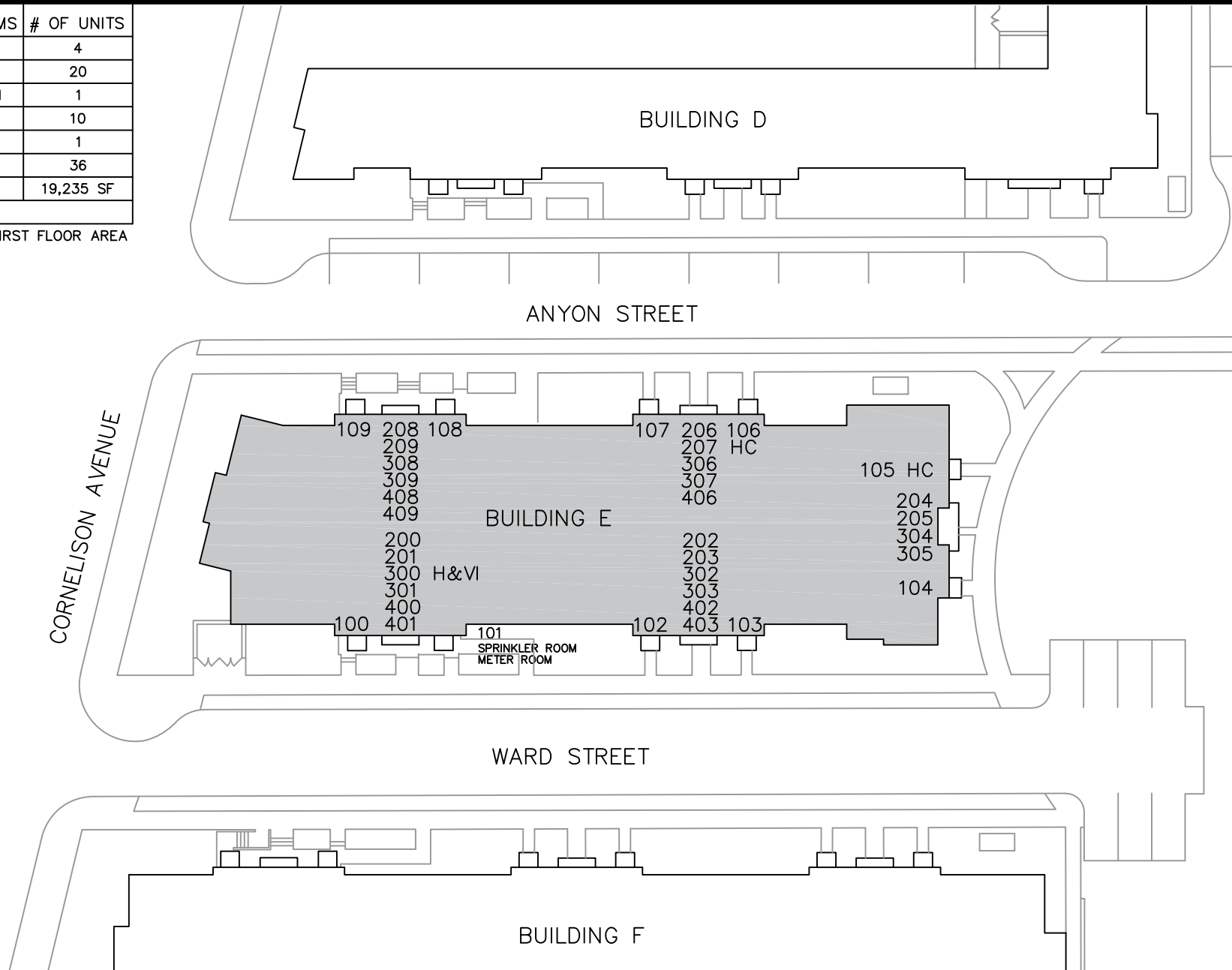

WARD F: Bergen Lafayette
 ZONE: R-4 Multi-Family High-Rise

OLD TAX BLOCK: 2116 LOT: P



PROJECT N.J. 9-26
 MONTGOMERY FAMILY PHASE I
 A.K.A. MILL CREEK GARDENS
 JERSEY CITY, NJ 07302

SITE PLAN
 BLOCK: 13602 LOT: 1.06
 REVISED: 02/2020
 PAGE 4 OF 5

SCALE:
 0' 10' 20' 40'



BEDROOMS	BATHROOMS	# OF UNITS
1 BR	1 BATH	1
2 BR	1 BATH	32
3 BR	2 BATH	8
TOTAL UNITS:		41
TOTAL BLDG. AREA*:		24,217 SF
SITE AREA:		0.556 AC

*GROSS FIRST FLOOR AREA

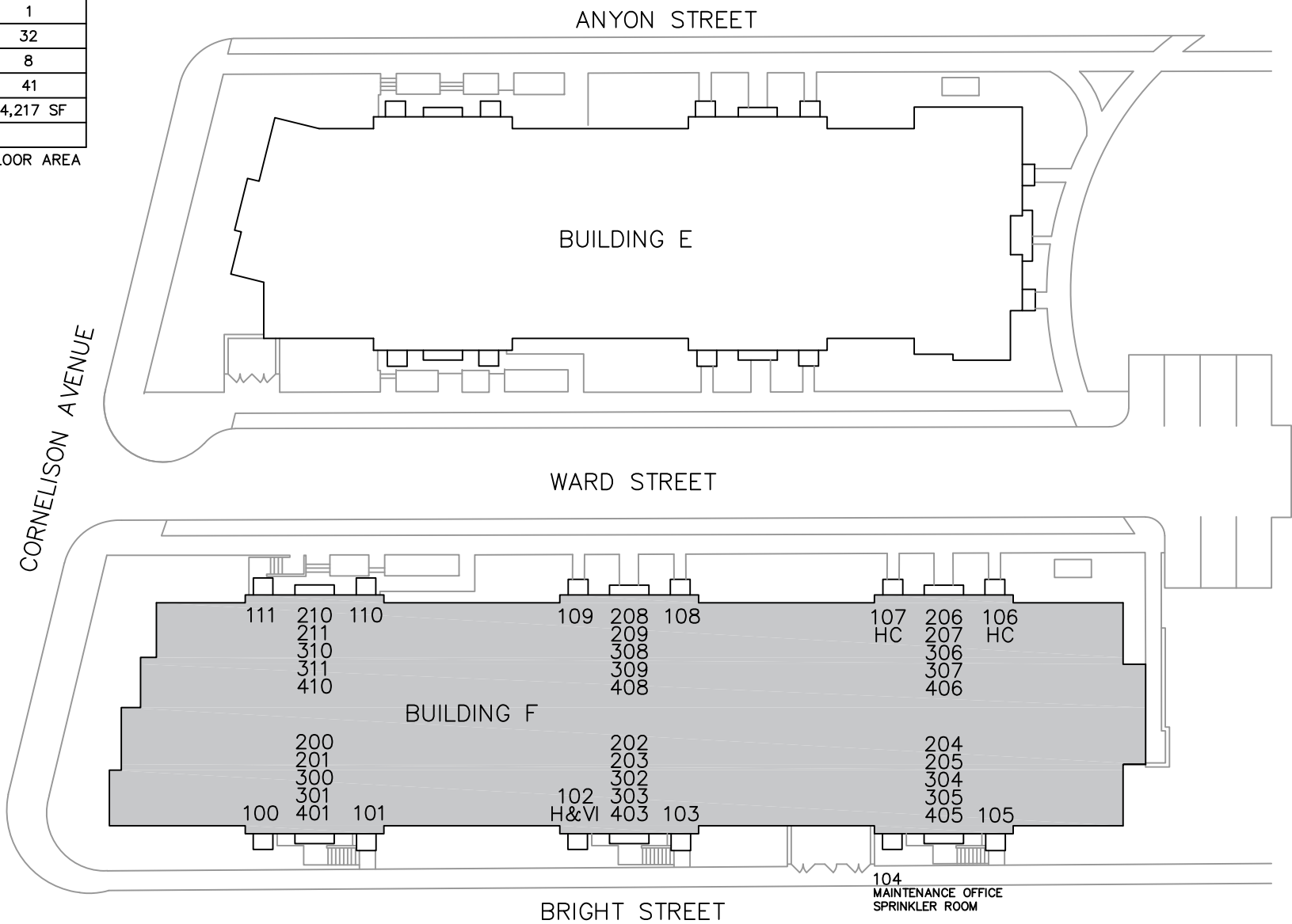

WARD F: Bergen Lafayette
ZONE: R-4 Multi-Family High-Rise

OLD TAX BLOCK: 2116 LOT: P



PROJECT N.J. 9-26
MONTGOMERY FAMILY PHASE I
A.K.A. MILL CREEK GARDENS
JERSEY CITY, NJ 07302

SITE PLAN
BLOCK: 13602 LOT: 1.04
REVISED: 02/2020
PAGE 5 OF 5

SCALE:
0' 10' 20' 40'



BLDG. #	ADDRESSES	# OF UNITS
PHASE I, N.J. 9-17		
BUILDING A		24
11,612 SF*	39, 41, 43, 45, 47, 49, 51, 53, 55, 57, 59, 61, 63, 65, 67, 69 71, 73, 75, 77, 79, 81, 83, 85 HARVEY AVENUE 87 HARVEY AVENUE (METER ROOM)	
BUILDING B		42
16,612 SF*	8, 10, 12, 16, 20, 22, 26, 28, 30 HARVEY AVE. 7, 11, 13, 15, 19, 21, 23, 27, 29, 31 MARCY PLACE 18 HARVEY AVENUE (METER ROOM) 25 MARCY PLACE (METER ROOM)	
PHASE II, N.J. 9-19		
BUILDING C		18
6,487 SF*	4 HARVEY AVENUE 5 MARCY PLACE 354, 358 DUNCAN AVENUE 352, 360 DUNCAN AVE. (METER ROOM)	
BUILDING D		24
8,148 SF*	340, 344, 348 DUNCAN AVENUE 6 MARCY PLACE (METER ROOM)	
BUILDING E		36
14,057 SF*	10, 12, 14, 18, 20, 24, 28, 30, 32 MARCY PLACE 11, 13, 15, 19, 23, 25, 29, 31, 33 GLORIA ROBINSON COURT 22 MARCY PLACE (METER ROOM) 21 GLORIA ROB. CT. (METER ROOM)	
SITE AREA: 4.19 AC		
TOTAL BLDG. AREA*: 56,916 SF		
TOTAL UNITS:		144
PHASE I TOTAL ACC UNITS:		58
PHASE II TOTAL ACC UNITS:		71

*GROSS FIRST FLOOR AREA

WARD B: West Side
ZONE: R-3 Multi-Family Mid-Rise

STATE HIGHWAY NO. 1

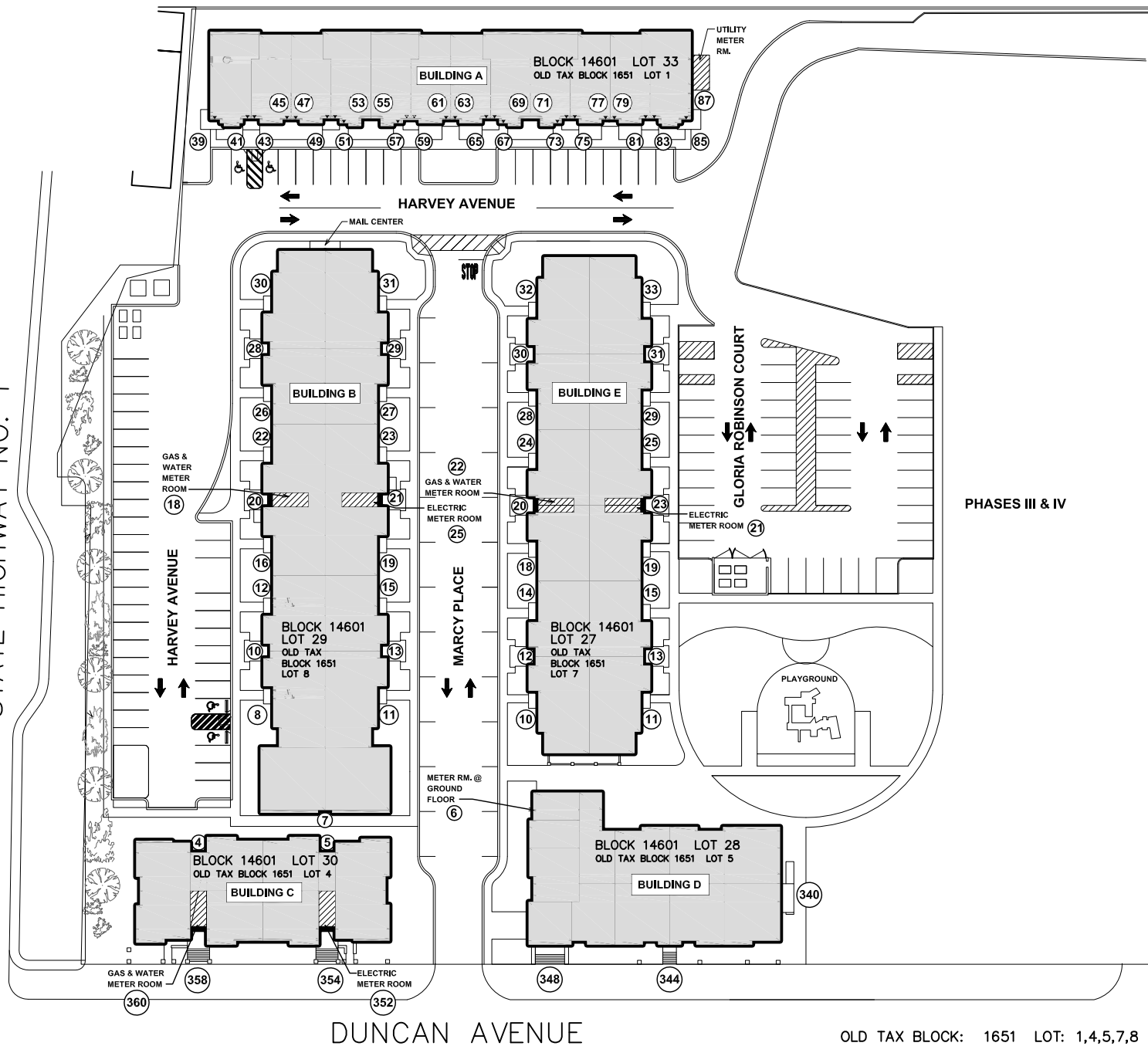

OLD TAX BLOCK: 1651 LOT: 1,4,5,7,8



PROJECT N.J. 9-17, 9-19
GLORIA ROBINSON COURT HOMES
PHASE I & II
JERSEY CITY, NJ 07306

SITE PLAN
BLOCK: 14601 LOT: 27-30, 33
REVISED: 02/2020

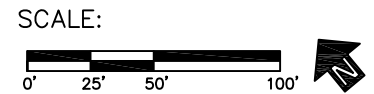

BLDG. #	ADDRESSES	# OF UNITS
PHASE III, N.J. 9-22		
BUILDING F		24
11,612 SF	99, 101, 103, 105, 107, 109, 111, 113, 115, 117, 119, 121, 123, 125, 127, 129, 131, 133, 135, 137, 139, 141, 143, 145 HARVEY AVENUE METER ROOM: 97 HARVEY AVENUE	
BUILDING G		36
14,057 SF	10, 12, 14, 18, 20, 24, 28, 30, 32 GLORIA ROBINSON COURT 11, 13, 15, 19, 23, 25, 29, 31, 33 WILMOT AVENUE METER ROOMS: 22 GLORIA ROBINSON COURT 21 WILMOT AVENUE	
SITE AREA: 1.92 AC		
TOTAL BLDG. AREA*: 25,669 SF		
TOTAL UNITS:		60
PHASE III TOTAL ACC UNITS:		24

*GROSS FIRST FLOOR AREA

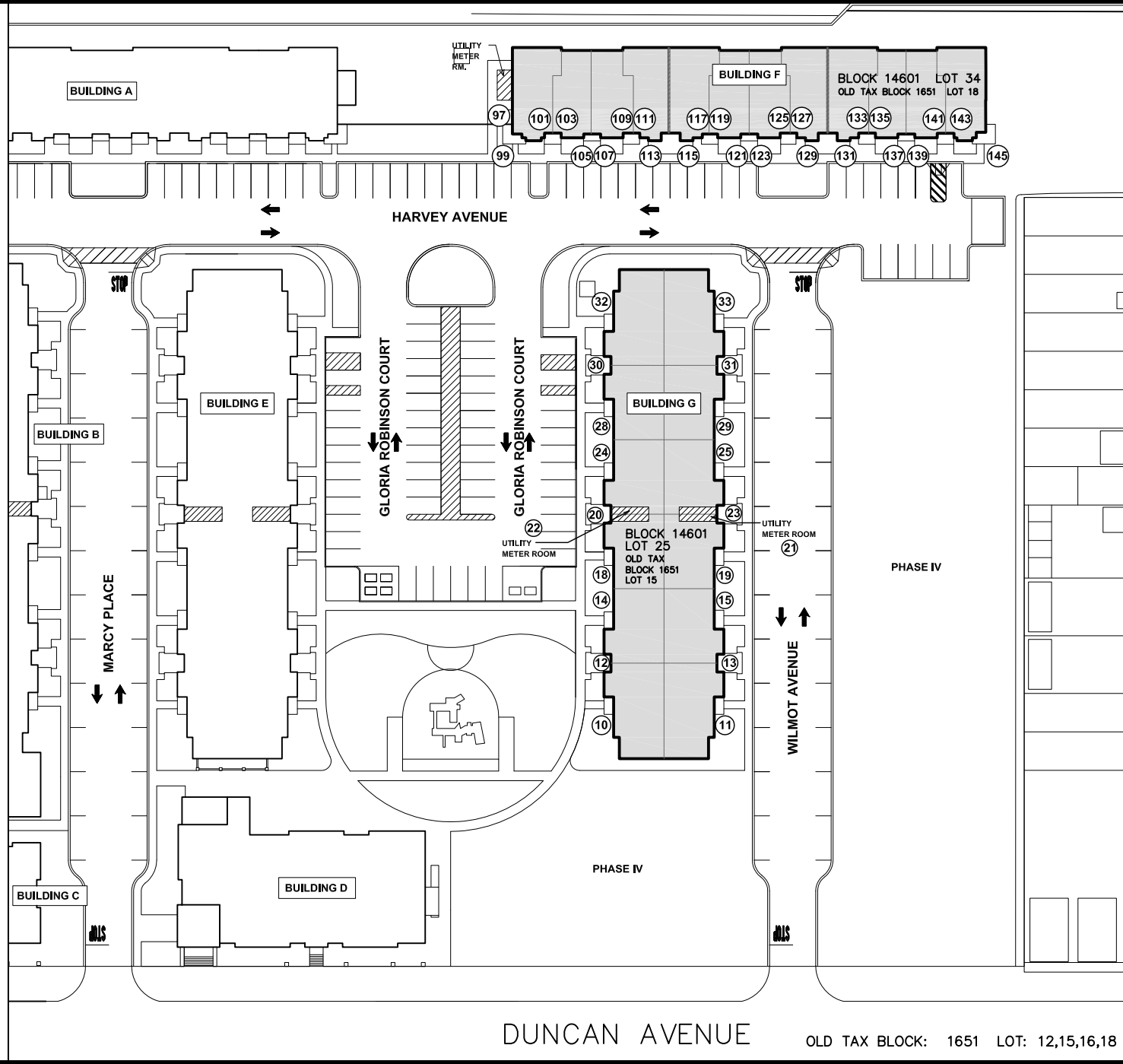

WARD B: West Side
ZONE: R-3 Multi-Family Mid-Rise



PROJECT N.J. 9-22
GLORIA ROBINSON COURT HOMES
PHASE III
JERSEY CITY, NJ 07306

SITE PLAN

BLOCK: 14601 LOT: 24,25,34,35

REVISED: 02/2020

SCALE:

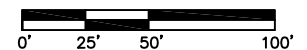

BLDG.#	ADDRESSES	# OF UNITS
PHASE IV, N.J. 9-24		
BUILDING H		20
9,230 SF	6 GLORIA ROBINSON COURT	
	HEAD START SCHOOL 330 DUNCAN AVENUE	
	METER ROOM: 7 WILMOT AVENUE	
BUILDING J		22
6,808 SF	2, 4, 6, 8, 10 WILMOT AVENUE	
	PENNROSE MANAGEMENT OFFICE 322 DUNCAN AVENUE	
BUILDING K		20
10,552 SF	14, 16, 18, 20, 22, 24, 26, 28, 30, 32, 34, 36, 38, 40, 42, 44, 46, 48, 50 WILMOT AVENUE 136 HARVEY AVENUE	
	METER ROOM: 12 WILMOT AVENUE	
BUILDING L		8
4,053 SF	149, 151, 153, 155 HARVEY AVENUE 229, 231, 233, 235 FREEMAN AVENUE	
	METER ROOM: 237 FREEMAN AVENUE	
SITE AREA: 1.51 AC		
TOTAL BLDG. AREA*: 30,643 SF		
TOTAL UNITS:		70
PHASE IV TOTAL ACC UNITS:		27
*GROSS FIRST FLOOR AREA		

WARD B: West Side
ZONE: R-3 Multi-Family Mid-Rise

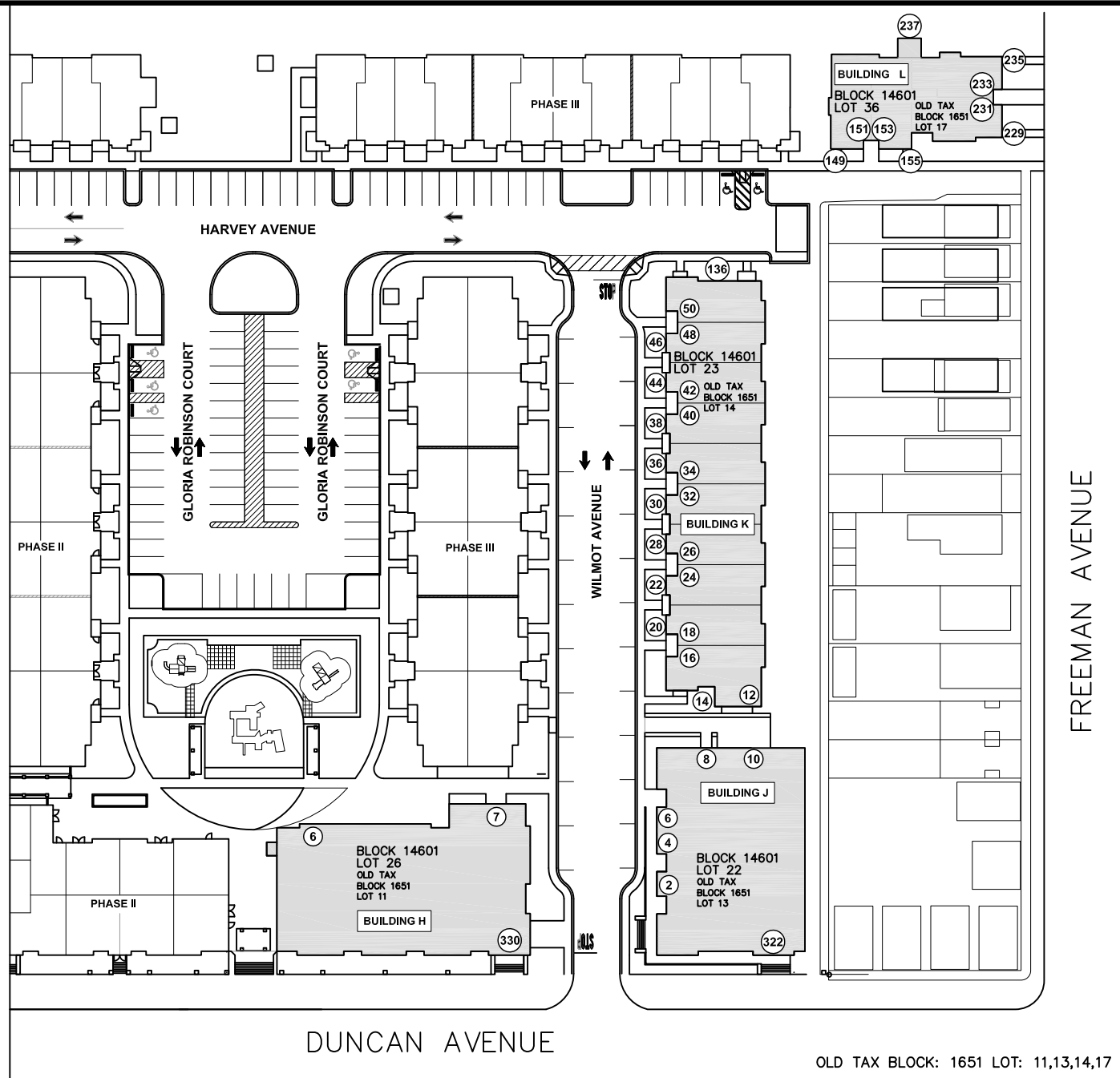

PROJECT N.J. 9-24
GLORIA ROBINSON COURT HOMES
PHASE IV
JERSEY CITY, NJ 07306

SITE PLAN

BLOCK: 14601 LOT: 22,23,26,36

REVISÉD: 02/2020

SCALE:

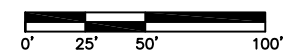

X:\JCHA Site Maps\Updated 2020\NJ9-24 Gloria Robinson Court Homes Phase IV.dwg